

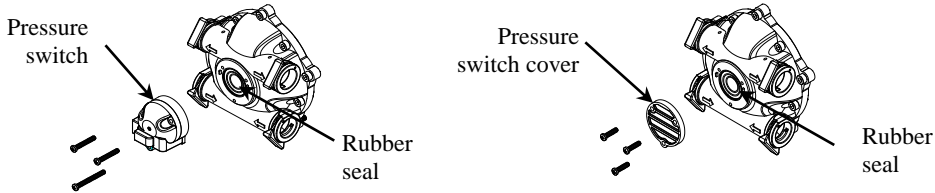

# EA157155A

ITEM NUMBER: A157155

## ASSEMBLY INSTRUCTIONS

<b>Personal protective equipment</b>	<b>Wear personal protective equipment as directed on the chemical label while servicing your pump.</b>
<b>To replace pump cartridge with pressure switch cover (skip to next step if replacing pump cartridge with pressure switch)</b>	<ol style="list-style-type: none"> <li>1. Remove pressure switch from replacement pump cartridge. Make sure rubber seal remains in place.</li> <li>2. Install pressure switch cover using the included shorter screws.</li> </ol> 
<b>Disassembly Instructions</b>	<ol style="list-style-type: none"> <li>1. Disconnect power to the pump motor and be sure all system pressure is relieved by pulling spray gun trigger.</li> <li>2. Disconnect both red wires from the pressure switch (if applicable).</li> <li>3. Disconnect the black plug from the pump motor.</li> <li>4. Disconnect plumbing from pump ports.</li> <li>5. Using the supplied hex wrench, unthread the <b>silver</b> mounting screws (black screws can remain installed).</li> <li>6. Slide the pump cartridge off the shaft of the motor. Discard the pump cartridge.</li> <li>7. Dry any wet areas of the motor before installing the new pump cartridge.</li> </ol>
<b>Assembly Instructions</b>	<ol style="list-style-type: none"> <li>1. Align the flat spots of the pump cartridge and motor shaft and slide the pump cartridge onto the shaft of the motor while lining up the holes in the pump cartridge to the holes in the motor face.</li> <li>2. Using the supplied hex wrench, secure the pump cartridge using the new mounting screws supplied with the pump cartridge.</li> <li>3. Attach both red wires to the pressure switch (if applicable).</li> <li>4. Attach the black plug from the pump cartridge to the pump motor.</li> <li>5. Reconnect plumbing to pump ports.</li> <li>6. Reconnect power to the pump and test system for leaks with water.</li> </ol>

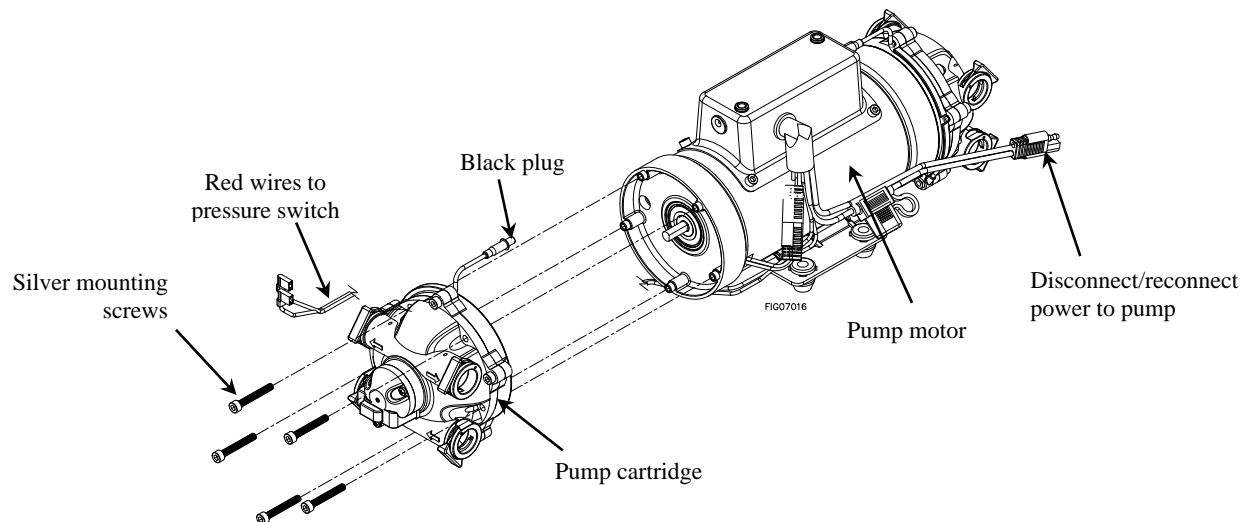

**Any Questions, Comments, Problems, or Parts Orders**  
**Call NorthStar Product Support at 1-800-270-0810**