



M2681781H

MODEL NUMBER: 2681781

SERIAL NUMBER: _____

Owner's Manual

Instructions for Assembly, Testing, Operation, Servicing, and Storage

NorthStar 3-Point Sprayer: Category 1 tractor implement for outdoor use with agricultural pesticides and other liquids**

⚠ WARNING

READ and UNDERSTAND the Owner's Manual completely before using this sprayer.

Assemble, test, and use only in accordance with the Owner's Manual instructions.

READ and FOLLOW chemical label instructions. Pesticides are hazardous chemicals.

KNOW emergency procedures BEFORE handling chemicals. Sprayer leaks, bodily chemical contact, poisoning, and spills require immediate response.

AVOID inhaling, ingesting, or coming into contact with any chemicals.

WEAR personal protective gear when filling, using, cleaning, and servicing the sprayer.

KEEP sprayer and spray materials away from children and pets. Pesticides are especially toxic to them.

EXERCISE CAUTION in vehicle handling when towing/hauling a filled sprayer to avoid loss of control or sprayer overturning.

ALWAYS keep a fire extinguisher rated "ABC" nearby

DO NOT TURN ON POWER to sprayer until ready to spray in order to avoid unintentional spray release.

Improper use of the sprayer or handling of chemicals could result in serious injury or illness to the operator or nearby persons/animals, or could cause damage to the environment.

**This sprayer is recommended for use in spraying non-flammable liquids such as pesticides, water for plants/trees or dust control, and water-based non-flammable sealants or stains for outdoor wood surfaces. The sprayer will be damaged and warranty voided if used to apply bleach, chlorine, ice control chemicals, or any petroleum based product (gasoline, diesel, kerosene, oil). The sprayer should not be used to transfer any product intended for human consumption. WE RECOMMEND THAT THE SPRAYER NOT BE USED FOR OTHER PURPOSES ONCE IT HAS BEEN USED FOR SPRAYING PESTICIDES. Any chemical will leave some residual in the tank liner or sprayer components, even after the sprayer has been properly cleaned. These residual chemicals can have unexpected effects on future uses. For example, spraying water or other liquids that are contaminated with residual pesticide may result in unforeseen hazards to plant or animal life. This sprayer should not be used by people with reduced physical, sensory or mental capabilities or lack of experience and knowledge.

Any Questions, Comments, Problems, or Parts Orders
Call NorthStar Product Support 1-800-270-0810

Hazard Signal Word Definitions





	<p>This is the safety alert symbol. It is used to alert you to potential personal injury hazards. Obey all safety messages that follow this symbol to avoid possible injury or death.</p>
	<p>DANGER (red) indicates an imminently hazardous situation which, if not avoided, will result in death or serious injury.</p>
	<p>WARNING (orange) indicates a potentially hazardous situation which, if not avoided, could result in death or serious injury.</p>
	<p>CAUTION (yellow) indicates a potentially hazardous situation which, if not avoided, may result in minor or moderate injury.</p>
	<p>CAUTION (yellow) used without the safety alert symbol indicates a potentially hazardous situation which, if not avoided, may result in property damage.</p>

fig01453

Table of Contents

Intended Use	4
Summary of Important Safety Information	5
During Assembly	
During Operation	
• General Chemical Safety	
• Chemical Application Safety	
• Transporting Safety	
• Chemical Accident Procedures	
Warning Label Location	8
Component Inventory	
Unpacking.....	9
Unpacking the Manual Bag	10
Assembly	
Step One: Attach legs	11
Step Two: Install lance clips	11
Step Three: Attach gun hose to pump.....	12
Step Four: Attach hose guide to frame and install hose hooks	12
Step Five: Attach gun hose to spray gun	13
Step Six: Attach broadcast nozzle	13
Step Seven: Connect sprayer to tractor.....	14
Step Eight: Connect remote switch to vehicle battery	15
Step Nine: Check and test completed assembly	16
Machine Components	17
Operation	
Important Safety Information - Operation	19
• General Chemical Safety	
• Chemical Application Safety	
• Transporting Sprayer	
• Chemical Accident Procedures	
Preparing the Sprayer for Each Use	23
Using the Sprayer	
Step One: Assess wind conditions and clear work area	25
Step Two: Fill the sprayer	25
Step Three: Operate the sprayer	27
Step Four: Clean sprayer and decontaminate after use.....	31
Storage	33
Preparing for storage	
Removing from storage	
Troubleshooting	34
Specifications	35
Parts Breakdown – Exploded View	36
Pump Exploded View	38
Appendix A: Broadcast Spray Calibration Tables	39
Limited Warranty	41

Intended Use

The sprayer is intended for use in spraying agricultural pesticides and other non-flammable liquids.

SPRAYING PESTICIDES:

Pesticides are hazardous chemicals that must be handled with caution as directed throughout this manual and on the pesticide label. Pesticides are regulated by the United States Environmental Protection Agency (EPA) and defined as:

Any substance or mixture of substances intended for preventing, destroying, repelling, or mitigating any pest. Though often misunderstood to refer only to insecticides, the term pesticide is a comprehensive term that applies to insecticides, herbicides, fungicides, and various other substances used to control pests.

The sprayer is intended for use in spraying pesticides in liquid form only. The sprayer is NOT intended for use in spraying pesticides in dry or aerosolized form, or for use with fumigants.

This sprayer is equipped with a spot spray gun and a broadcast spraying system. Use the spot spray gun if you desire to apply pesticide only on selected plants. Use the broadcast spraying system if you wish to spray large ground areas.

SPRAYING OTHER LIQUIDS:

In addition to spraying pesticides, this sprayer may be used to spray other **non-flammable** liquids. Example uses include: watering plants/trees or spraying water for dust control, or applying water-based, **non-flammable** sealant or stain to outdoor wood surfaces. **WE RECOMMEND THAT THE SPRAYER NOT BE USED FOR OTHER PURPOSES ONCE IT HAS ALREADY BEEN USED FOR SPRAYING PESTICIDES.** Any chemical will leave some residual in the tank liner or sprayer components, even after the sprayer has been properly cleaned. These residual chemicals can have unexpected effects on future uses. For example, spraying water or other liquids that are contaminated with residual pesticide may result in unforeseen hazards to plant or animal life.

NOTE: The sprayer will be damaged and warranty voided if used to apply bleach, chlorine, ice control chemicals, or any petroleum based product (gasoline, diesel, kerosene, oil).

Contact NorthStar Product Support at 1-800-270-0810 for any questions about the appropriate use of the sprayer and/or optional accessories.

Summary of Important Safety Information

WARNING

Read and understand **this owner's manual** completely before using the sprayer. Read each **chemical label's instructions** before handling the chemical.

Improper use of the sprayer or handling of chemicals could result in serious injury or illness for the operator or nearby persons/animals, or cause damage to the environment.

LISTED BELOW is a summary of safety information of particular importance. See individual sections of this owner's manual for more details.

----- DURING ASSEMBLY -----

- **EXERCISE CAUTION when attaching remote switch to battery terminals.** Follow the steps listed in the Assembly section of this manual in *exact sequence* when connecting the sprayer's remote switch battery clamps to the battery terminals. *Caution must be exercised to avoid contact with battery acid and to prevent sparking.*
- **CHECK and TEST completed assembly** as directed in this manual. Serious injury could result from chemical leaks if sprayer is improperly assembled.
- **DO NOT MODIFY sprayer design.**

----- DURING OPERATION -----

General Chemical Safety

- **READ and FOLLOW** each chemical label's instructions and warnings.
- **AVOID** inhaling, ingesting, or coming into contact with any chemicals.
- **KNOW** applicable licensing and regulatory requirements for the chemical you plan to use.
- **KNOW** emergency procedures before handling chemicals. Carefully review "Chemical Accident Procedures" listed below and later in this manual. Also see First Aid instructions on the chemical label.
- **WEAR** protective clothing, eye protection, and chemical resistant gloves when filling, using and cleaning the sprayer. Wear additional protective gear, such as facemask or apron, as recommended on the chemical label.
- **EXERCISE EXTRA CAUTION around children and pets.** Pesticides are especially toxic to them. Keep sprayer and spray materials away from them at all times.
- **DO NOT MIX OR POUR** chemicals in an enclosed, unventilated area
- **DO NOT USE** flammable or corrosive chemicals in the sprayer.
- **FLUSH** the sprayer before switching chemicals in order to prevent dangerous chemical interactions.
- **STORE** pesticides in a correctly labeled container and in a secure location.
- **MONITOR** the health of operators frequently exposed to pesticides, as recommended by the chemical label or local/federal regulations.

Chemical Application Safety

Before Spraying

- **INSPECT and PREPARE** sprayer before each use as directed in this manual.
- **DO NOT TURN ON POWER** to sprayer until ready to spray in order to avoid unintentional spray release.
- **MAKE SURE BROADCAST NOZZLE IS ORIENTED to spray straight down** before starting the sprayer. An incorrectly positioned broadcast nozzle may spray chemicals on you or others.
- **DO NOT SPRAY** when wind speed exceeds 4 MPH in order to minimize spray drift.
- **CLEAR** work area of people/ pets and **POST** warning notices to restrict access for the period recommended on chemical label.
- **KEEP** sprayer and spray materials away from children/pets. Pesticides can be especially toxic to children and animals.
- **DO NOT ALLOW** anyone younger than 16 to operate sprayer since pesticides are especially toxic to children.

Summary of Important Safety Information (continued)

During Spraying

- **DO NOT OVERAPPLY pesticide.** Apply at rate recommended by chemical manufacturer. Excess pesticide can be dangerous to humans/animals, damage desirable plants, and contaminate soil and water sources.
- **DO NOT EAT, DRINK, SMOKE, RUB YOUR EYES, or TOUCH YOUR BARE SKIN while handling chemicals and spraying.**
- **NEVER POINT THE SPRAY GUN at people or animals.**
- **EXERCISE EXTRA CAUTION when spraying near areas accessible to children and pets.**
- **CLEAN up spills immediately** per instructions on the chemical label.
- **TURN OFF vehicle and set brake or block wheels, TURN OFF power to sprayer, and RELIEVE system pressure** before leaving sprayer unattended.
- **SEE Troubleshooting section of this manual before attempting any repairs.** Wear personal protective equipment and follow safety instructions.

After Spraying

- **CLEAN sprayer immediately after use** according to the directions provided in this manual.
- **DECONTAMINATE yourself after you are done spraying** and have cleaned the sprayer. Wash all exposed areas of the body with soap and water, and remove and launder clothing.
- **DISPOSE OF or STORE remaining chemicals in secure storage with correctly marked container.**

Transporting Safety

READ safety instructions in your vehicle manual with regard to carrying heavy cargo loads.

- **DO NOT ALLOW drivers younger than 16** to drive the vehicle with the filled sprayer attached.
- **MAKE SURE SPRAYER IS SECURELY ATTACHED to vehicle.**
- **EXERCISE CAUTION in vehicle handling when driving with filled sprayer** to avoid loss of control or rollover.
 - **Keep speed to a minimum** so you can maintain control. Reduce speed prior to turns.
 - **Allow for more distance to stop.**
 - **Avoid any sudden** steering maneuvers, starts, or stops that could create liquid sloshing in the sprayer and instability.
- **SLOW DOWN and EXERCISE EXTRA CAUTION on sloped or uneven terrain.** Pick the most level route possible across fields--drive up and down slopes when necessary, rather than across. Use a vehicle equipped with a roll over protection system (ROPS) if you will be working on non-level terrain.
- **BE AWARE that visibility may be reduced** when making turns or backing up.
- **DO NOT RIDE or TRANSPORT cargo on the sprayer.**
- **TURN OFF both sprayer and vehicle, and SET BRAKES** before leaving unattended.

Summary of Important Safety Information (continued)

Chemical Accident Procedures

Immediate response is necessary in the event of sprayer leaks, bodily chemical contact, poisoning, or spills. See instructions below:

Sprayer leak	If the sprayer develops a leak, <i>immediately stop spraying</i>. Turn off power to the sprayer and follow directions below, as applicable.
Bodily chemical contact	<p>Personal contamination can occur when chemicals splash, spill, or spray directly onto a person.</p> <ol style="list-style-type: none"> 1. Immediately follow First Aid instructions on <u>chemical label</u>. <u>General procedures can include:</u> <ol style="list-style-type: none"> a) Eyes – immediately flush with water. b) Skin – wash all contaminated skin surfaces with soap and water. c) Clothing – remove contaminated clothing. Dispose of heavily contaminated clothing per chemical label instructions. 2. Seek medical advice if instructed on the label or the victim experiences symptoms of harmful effects. Bring the chemical label for reference.
Poisoning by ingestion or inhalation	<p>In case of poisoning from ingestion or inhalation:</p> <p><i>If the victim has collapsed or is not breathing, <u>call 911</u>.</i> Otherwise:</p> <ol style="list-style-type: none"> 1. If you are the victim, immediately seek assistance from nearby personnel because you may become incapacitated. 2. Immediately follow first aid instructions on <u>chemical label</u>. 3. Call a poison control center for further advice. In the U.S., call 1-800-222-1222. Have the chemical label available for reference.
Chemical spills	<p>Chemical spills must be quickly contained and properly cleaned up.</p> <p>Refer to the chemical label for any specific clean-up instructions.</p> <p><u>General procedures include:</u></p> <ol style="list-style-type: none"> 1. Controlling the spill by stopping the source of the spill. 2. Containing the spill so that it does not spread and get into water sources. 3. Cleaning up the spill immediately. 4. Seeking additional advice from: <ul style="list-style-type: none"> - <u>Chemical manufacturer</u>. See chemical label for contact information. - <u>State pesticide regulatory agency</u>. In the U.S., call the National Pesticide Info. Ctr. at 800-858-7378 for assistance in contacting your state's agency.

Warning Label Location

WARNING

READ and UNDERSTAND the Owner's Manual completely before using this sprayer.

Assemble, test, and use only in accordance with the Owner's Manual instructions.

READ and FOLLOW chemical label instructions. Pesticides are hazardous chemicals which must be handled carefully.

KNOW emergency procedures BEFORE handling chemicals. Sprayer leaks, bodily chemical contact, poisoning, and spills require immediate response.

AVOID inhaling, ingesting, or coming into contact with any chemicals.

EXERCISE CAUTION in vehicle handling. Vehicle will be less stable and handle very differently with filled sprayer attached.

DO NOT TURN ON POWER to sprayer until ready to spray in order to avoid unintentional spray release.

Improper use of the sprayer or handling of chemicals could result in serious injury or illness to the operator or nearby persons/animals, or could cause damage to the environment.

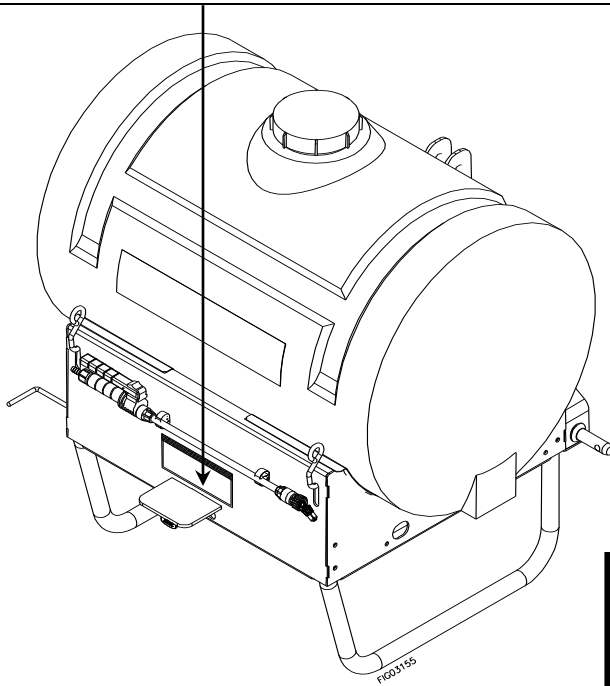

WARNING

DO NOT PUMP FLAMMABLE FLUIDS. DO NOT USE PUMP IN AN EXPLOSIVE ENVIRONMENT. READ AND UNDERSTAND THE OWNER'S MANUAL COMPLETELY BEFORE USING. RELIEVE SYSTEM PRESSURE BEFORE PERFORMING MAINTENANCE.

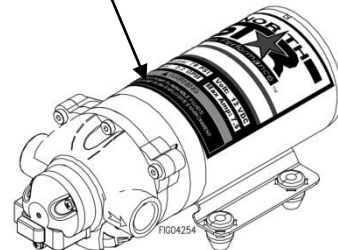

Part#	Description
777499	Chemical Label
788009	NSQ Series 2272Q Pump Label

Always make sure safety labels are in place and in good condition. If a safety label is missing or not legible, order new labels or unsafe operation could result.

To order replacement safety labels, call NorthStar Product Support at 1-800-270-0810.

Unpacking Machine Components

Closely inspect all contents

Note that some parts are shipped inside the tank.

- If you have missing or damaged components, please contact NorthStar Product Support at 1-800-270-0810.

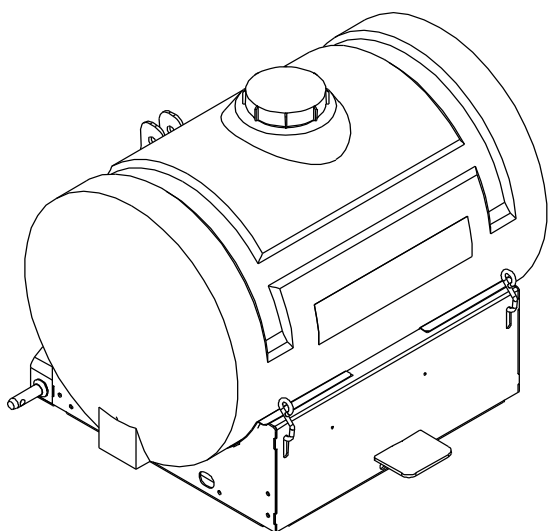

SPRAYER
TANK

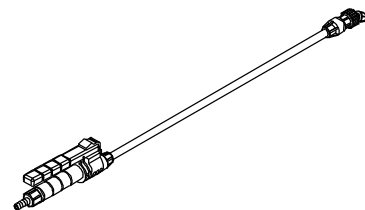

SPRAY
GUN

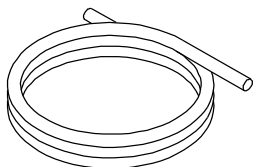

GUN
HOSE

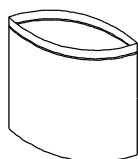

MANUAL
BAG

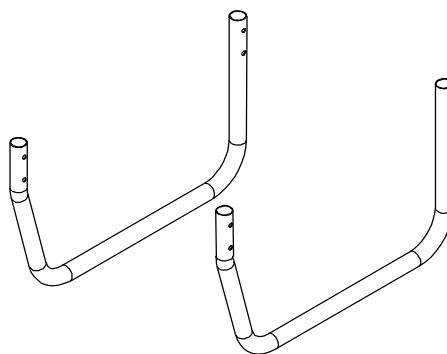

LEGS

FIG03156

Unpacking the Manual Bag

The following items are found in the 2681781 manual bag:

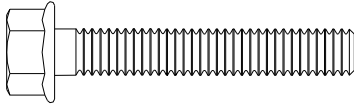

5/16 x 2" Bolt
Qty. 8
(Part #82018)



5/16 Nut
Qty. 12
(Part # 82019)

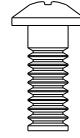

#10 x 1/2" Screw
Qty. 2
(Part # 82059)



#10 Nut
Qty. 2
(Part # 82065)

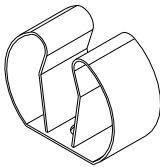

Lance clip
Qty. 2
(Part # 52034)

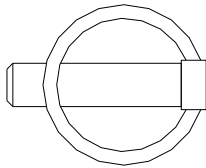

Lynch pin
Qty. 2
(Part # 39159)

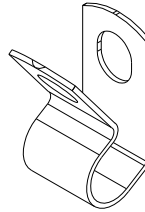

Hose guide
Qty. 1
(Part # 777110)

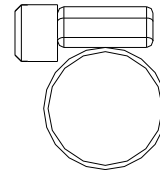

Hose clamp
Qty. 2
(Part # 30746)

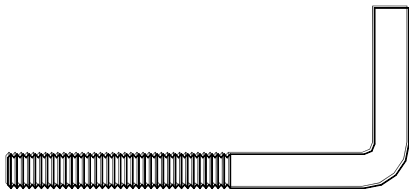

Threaded hose hook
Qty. 2
(Part # 38510)

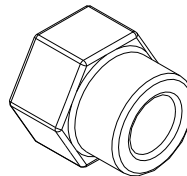

Nozzle coupler
Qty. 1
(Part # 38545)

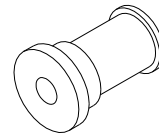

Anti-drip filter
Qty. 1
(Part # 253121)

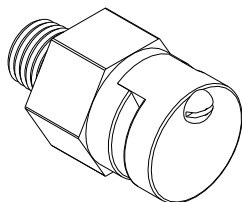

Broadcast nozzle
Qty. 1
(Part # 36576)

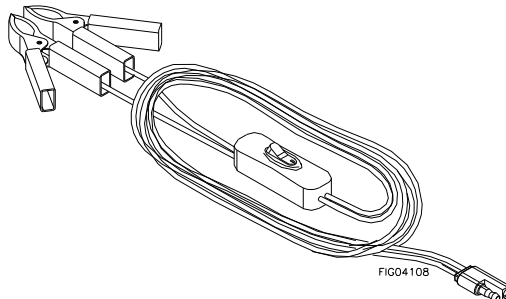

Remote switch
Qty. 1
(Part # 798370)

Assembly

Step One: Attach legs

Line the holes of the legs up with the holes in the frame and fasten with 8 bolts and 8 nuts

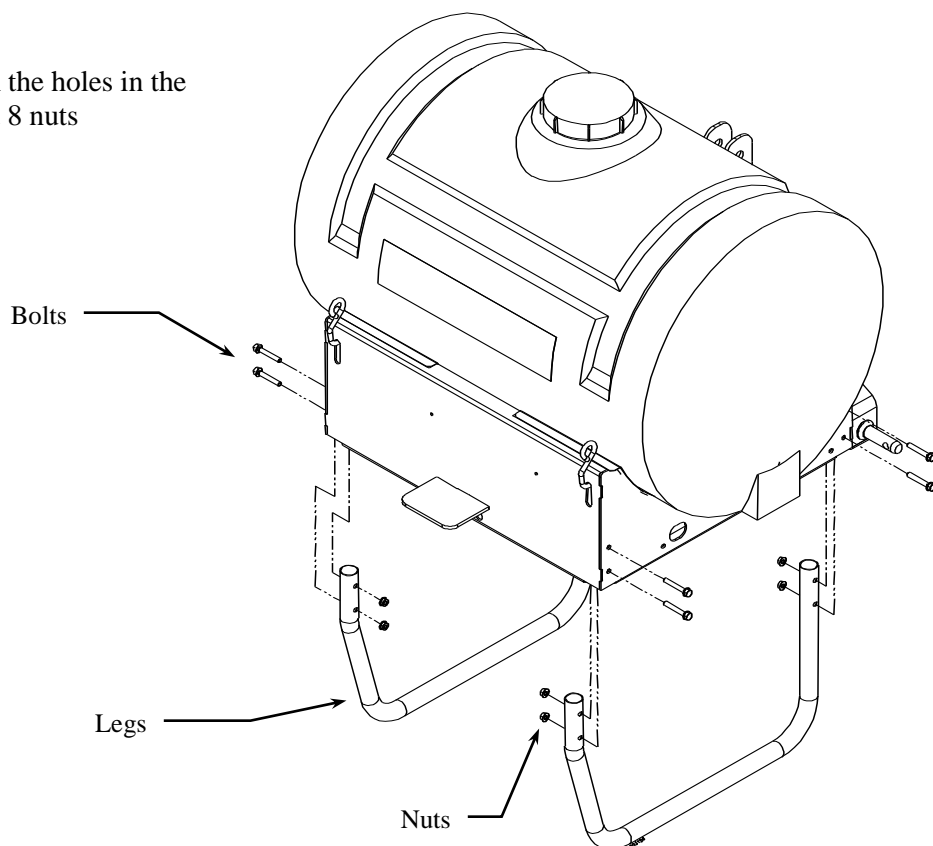

Step Two: Install lance clips

Fasten the two lance clips to the sprayer frame with the 2 screws and 2 #10 nuts

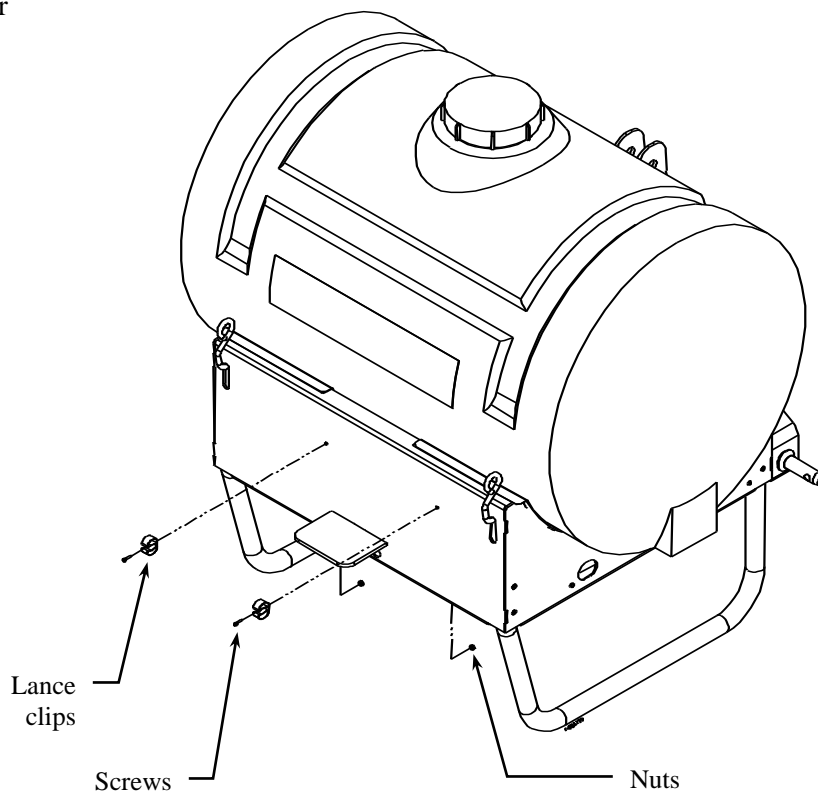

Assembly (continued)

Step Three: Attach gun hose to pump

1. Install hose clamp on hose.
 - i) Slide hose clamp over the end of the hose.
 - ii) Push the hose onto the hose barb.
 - iii) Slide the hose clamp over the hose barb.
 - iv) Tighten the hose clamp.
2. Attach one end of the gun hose to the pump hose barb.

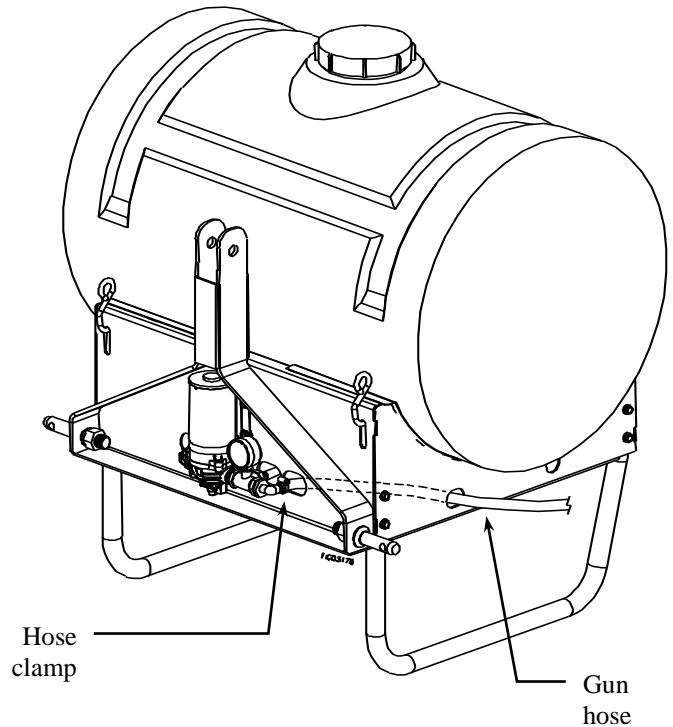

Step Four: Attach hose guide to frame and install hose hooks

1. Route gun hose through hose guide.
2. Thread nuts onto hose hooks as shown
3. Align the hose guide to the hole in frame – Note orientation
4. Fasten hooks to frame with 2 nuts – Note orientation
5. To secure the hose, wrap it around the hooks

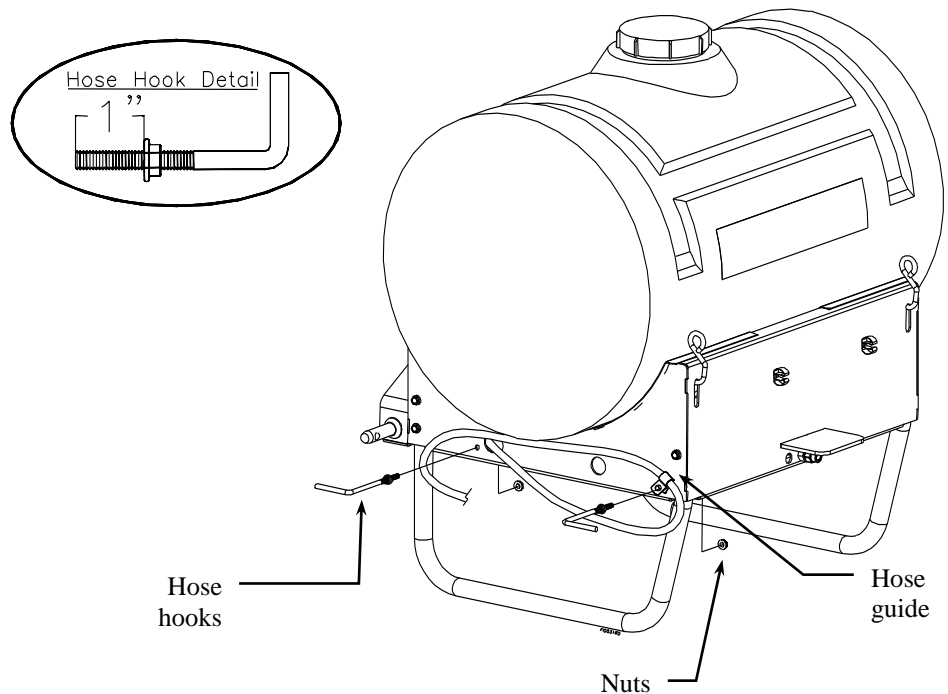

Assembly (continued)

Step Five: Attach gun hose to spray gun

1. Install hose clamp on hose.
 - i) Slide hose clamp over the end of the hose.
 - ii) Push the hose onto the hose barb.
 - iii) Slide the hose clamp over the hose barb.
 - iv) Tighten the hose clamp.
2. Attach the end of the gun hose to the gun hose barb.

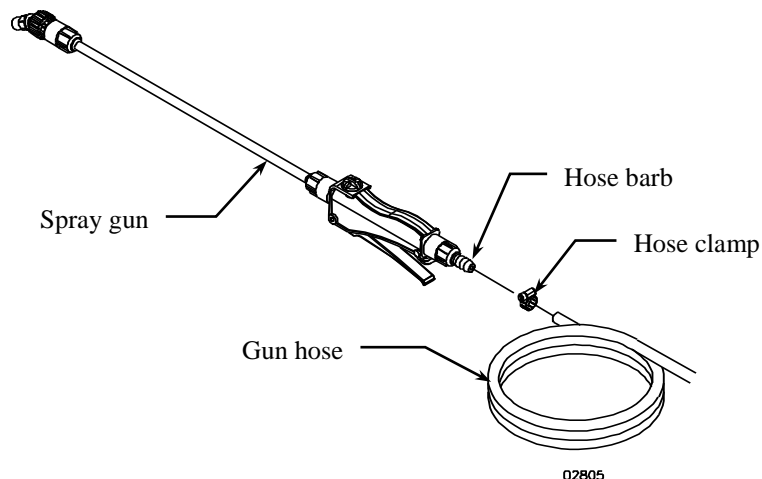

Step Six: Attach broadcast nozzle

1. Insert anti-drip nozzle filter into 11/16" x 1/2" Hose barb – Note orientation
2. Thread larger 11/16" side of nozzle coupler onto 11/16" x 1/2" Hose barb
3. Thread broadcast nozzle into smaller 1/4" side of nozzle coupler

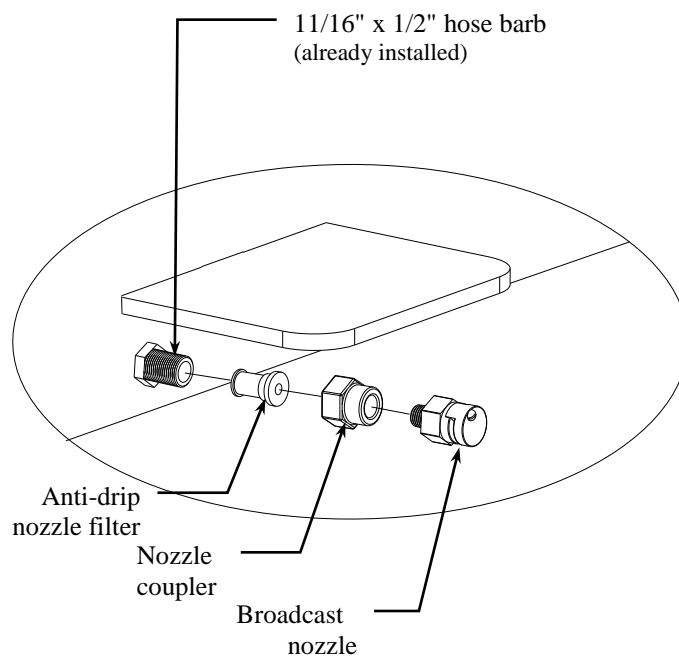
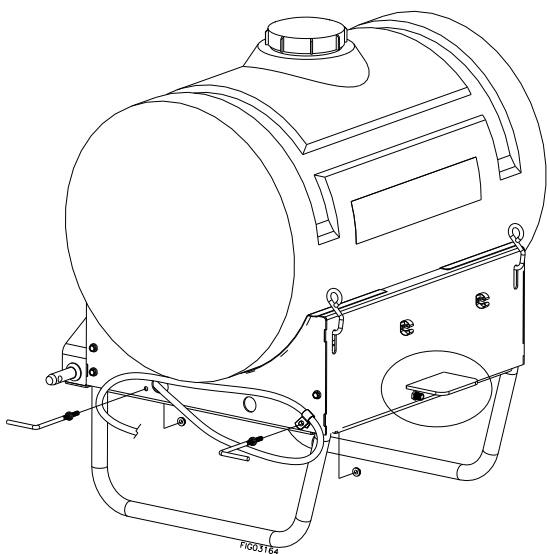

Assembly (continued)

Step Seven: Connect sprayer to tractor

⚠ WARNING

The sprayer must be correctly mounted and then attached to the tractor for safe operation. Follow the instructions below for safety mounting and connecting the sprayer.

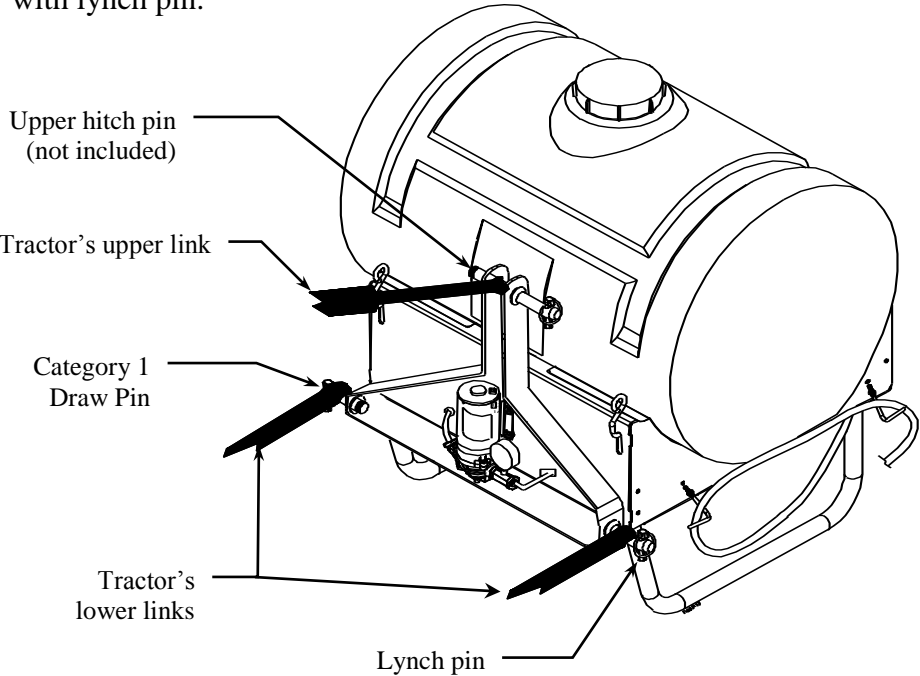
1. Read instructions	Review your tractor manual or check with your dealer for instructions and safety information about how to properly connect the sprayer to your tractor's hydraulics.
2. Tractor off & parking brake engaged	Turn off the tractor and engage the parking brake before attaching the sprayer.
3. Attach to tractor 3-point hitch links	<p>Attach sprayer to tractor's category 1, 3-point hitch links.</p> <ol style="list-style-type: none"> Connect the tractor's lower link to the lower hitch studs of the sprayer. Secure with lynch pins. Connect the tractor's upper link to the upper hitch pin of the sprayer. Secure with lynch pin.  <p>⚠ WARNING: An improperly attached sprayer could become dislodged during transportation or operation, which could result in serious injury to the operator or bystanders. Do not drive the tractor or operate the sprayer until you are sure the sprayer is properly attached and hitch pins are fully engaged.</p>

Assembly (continued)

Step Eight: Connect remote switch to vehicle battery

⚠ WARNING

Batteries are hazardous because they contain caustic acid, can emit explosive gases, and can cause electric shock.

Caution must be exercised when making connections to a battery to avoid shock and contact with the acid, and to prevent any sparking that could lead to an explosion.

ALWAYS follow the safety instructions and steps listed below in *exact sequence* when connecting the sprayer's remote switch to the battery terminals.

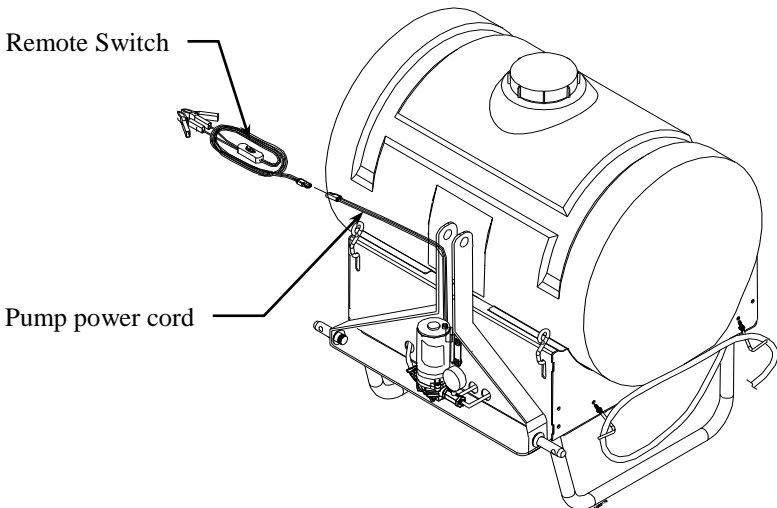
1. Preparatory safety	<p>Preparatory safety steps:</p> <ul style="list-style-type: none"> • ALWAYS use eye protection • NEVER smoke or work near sparks or other sources of ignition. • NEVER touch both battery terminals at the same time or with any non-insulated tools. • If battery acid contacts skin or clothing, flush immediately with water and neutralize with baking soda.
2. Connect remote switch to battery	<p>Connect the sprayer's <u>remote switch</u> to the vehicle battery using the following procedure:</p> <ol style="list-style-type: none"> Disconnect the vehicle battery ground wire. Connect the <u>remote switch's</u> red battery clamp to the positive(+) terminal of the battery. Connect the <u>remote switch's</u> black battery clamp to the negative(-) terminal of the battery. Reconnect the vehicle battery ground wire. <p>WARNING: Always connect in this sequence to avoid possible shock.</p>
3. Connect remote switch to pump power cord	<p>Connect the remote switch to the pump power cord:</p> <p>Note: Make sure the power switch is in the OFF position on the remote switch.</p> <div style="text-align: center;">  <p>The diagram shows a sprayer unit with a cylindrical tank. A remote switch is shown with two wires connected to the pump power cord on the side of the unit. Labels with leader lines point to the 'Remote Switch' and the 'Pump power cord' connection point.</p> </div>

Assembly (continued)

4. Verify connection	Verify a complete connection has been made by checking with a DC voltmeter, or by <i>briefly</i> turning the <u>remote switch</u> to the ON position and listening for pump activation.
5. Disconnect after use	<p>AFTER EACH USE, disconnect power to the sprayer by disconnecting the sprayer's <u>pump cord</u> from the <u>remote switch</u> – <i>the <u>remote switch</u> may remain connected to the battery.</i></p> <p><i>NOTE: It is important to disconnect power to the sprayer when not in use for safety reasons. ALWAYS verify that the power has been disconnected or the remote switch is in the OFF position before adding chemicals or servicing.</i></p>
6. To disconnect permanently	<p>When it is necessary to disconnect the sprayer's <u>remote switch</u> from the battery, use the following procedure:</p> <ol style="list-style-type: none"> 1. Disconnect <u>sprayer's pump cord</u> from the <u>remote switch</u>. 2. Disconnect the <u>remote switch</u> from the vehicle battery as follows: <ol style="list-style-type: none"> a) Disconnect vehicle battery ground wire. b) Disconnect the <u>remote switch's black</u> battery clamp from the <i>negative(-)</i> terminal of the vehicle battery. c) Disconnect the <u>remote switch's red</u> battery clamp from the <i>positive(+)</i> terminal of the vehicle battery. d) Reconnect the vehicle battery ground wire. <p>WARNING: Always disconnect in this sequence to avoid possible shock. <i>(Remember that on some vehicle models, you may need to remove the sprayer to access the battery)</i></p>

Step Nine: Check and test completed assembly.

WARNING

Check and test completed assembly

Serious injury could result from chemical leaks if sprayer is improperly assembled or the design of the sprayer is modified.
Follow the steps below to ensure the sprayer is properly assembled. Never modify the sprayer design.

1. Check assembly	<p>Check assembly to assure the sprayer is properly assembled and in safe working condition:</p> <ol style="list-style-type: none"> a) Check that the gun clip screws are tight, hose clamps are secure, and tank straps are properly fastened. b) While it is unlikely that factory assembled components become loose, they should also be checked to make sure they are tight.
2. Test with water	<p>Test the system for leaks with water:</p> <ol style="list-style-type: none"> a) Fill the tank with water. b) Connect the remote switch to the pump power cord and turn the remote switch ON. The pump is an "on demand" pump. When turned on, the pump will prime itself, then turn off. When the gun trigger is squeezed, the pump will automatically start. c) Operate the spray gun by squeezing the gun trigger. d) Check for leaks throughout the system. If a leak is detected, fix the leak and re-test the system with water until no leaks are detected.

Machine Components

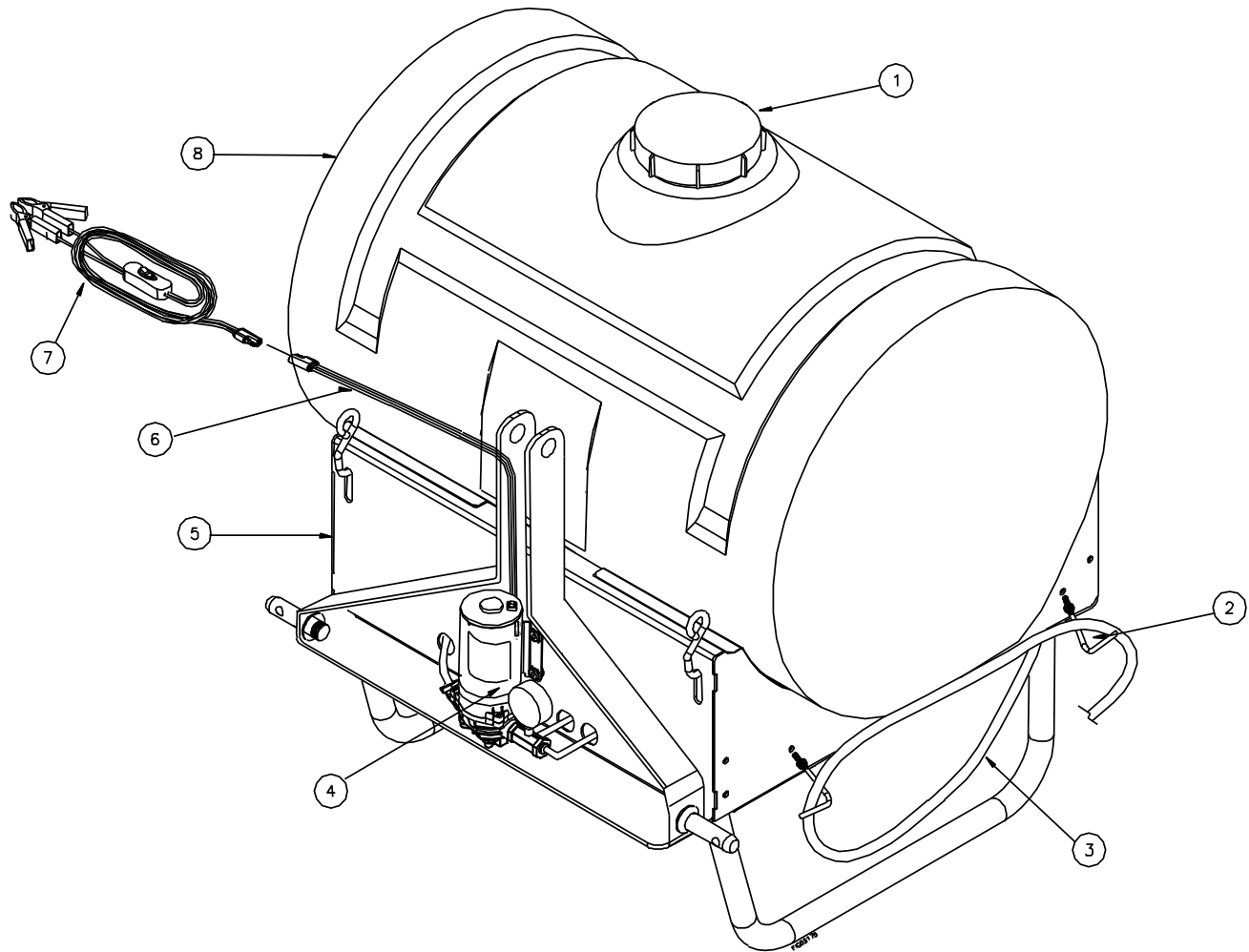

1. **Fill Cap.** The fill cap has a vent to allow air to enter the tank as the chemical is dispensed.
2. **Hose Hooks.** Provides a storage location for the gun hose
3. **Gun Hose.** The 15-foot gun hose transfers chemical from the pump to the spray gun.
4. **Sprayer Pump.** The sprayer pump makes the chemical flow to the spray gun and the broadcast nozzle.
5. **3 Point Frame.** Attaches to category 1 tractor.
6. **Pump Power Cord.** The pump power cord connects the sprayer pump to the remote switch. It should be disconnected when the sprayer is not in use.
7. **Remote Switch.** The remote switch connects the battery to the pump power cord and allows the operator to turn the sprayer pump on and off. The remote switch may be left connected to the battery when the sprayer is not in use.
8. **Sprayer Tank.** The sprayer tank holds the chemical.

Machine Components

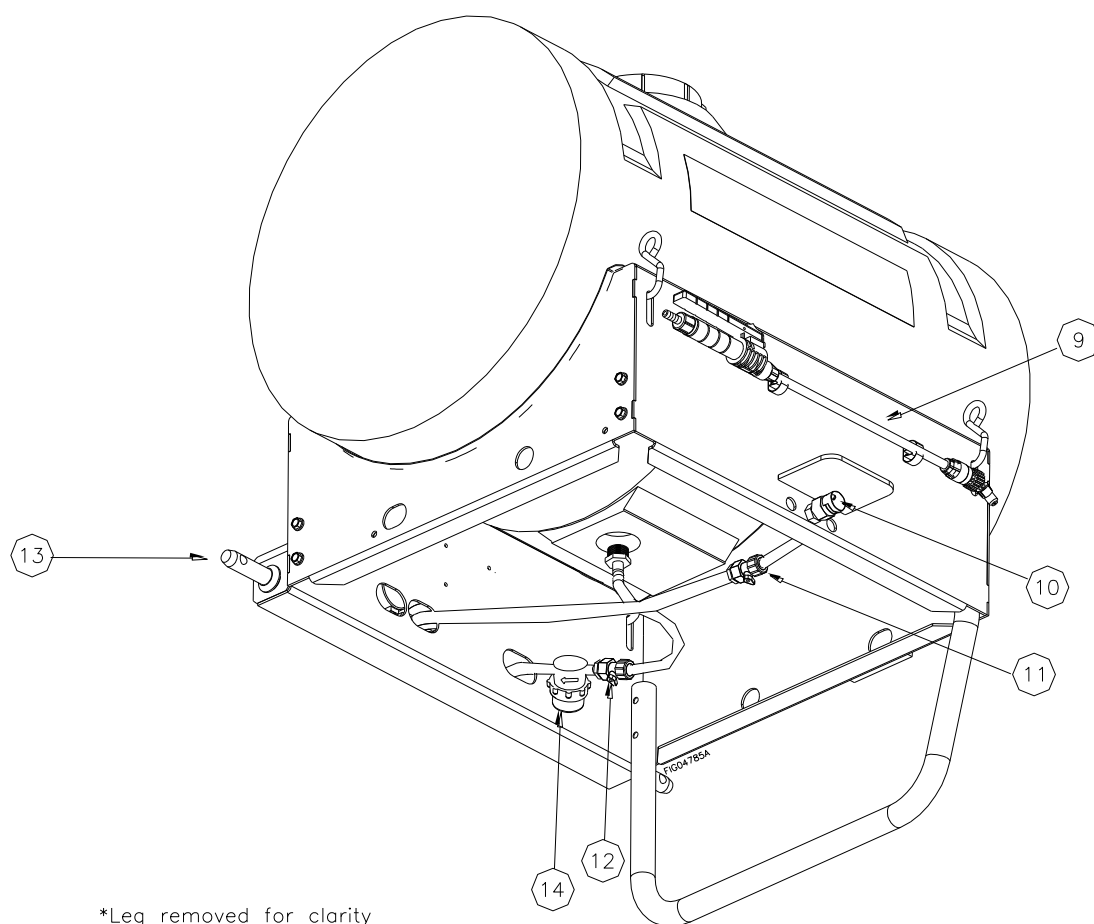

*Leg removed for clarity

- 9. Spray Gun.** Use the spot spray gun to apply chemical to specific areas. The spray pattern is adjustable from stream to cone by twisting the spray nozzle (see Operation Instructions). When the remote switch is in the ON position, the spray gun trigger is the pump ON/OFF control. Squeeze the trigger and the pump turns on, let go and the pump turns off.
- 10. Broadcast Nozzle.** Creates a single wide spray pattern for even coverage.
- 11. Broadcast Nozzle Shut Off Valve.** When valve is open it will let chemical go out to broadcast nozzle and when the valve is closed it will stop chemical from going out broadcast nozzle.
- 12. Tank Shut Off Valve.** When valve is open it will let chemical out of the tank into the pump inlet and when valve is closed it will stop chemical from tank to pump inlet.
- 13. Category 1 Draw Pin.** Allows a connection between the tractor 3 point and the frame.
- 14. Inline Filter.** Removes debris from the fluid supply between tank and pump inlet.

Operation – Important Safety Information

Now that you have completed and tested your assembly, there is some important safety and health information you need to know with regard to handling and spraying chemicals, as well as vehicle handling with the sprayer attached.

WARNING

Carefully read and make sure you understand the following safety information before using the sprayer.

General Chemical Safety:

WARNING

Pesticides are hazardous chemicals.
Heed the warnings below and follow all instructions carefully.
Improper handling of chemicals can result in serious injury or illness, or cause damage to the environment.

- **Chemical label.** ALWAYS READ and FOLLOW all chemical label instructions.
- **Licensing/regulation.** Refer to any applicable licensing restrictions or state/federal regulations with regard to the application of the particular chemical you plan to use.
- **Emergency procedures.** Before handling chemicals, carefully review the "[Chemical Accident Procedures](#)" listed later in this section, as well as the "Statement of Practical Treatment" on the chemical label.
- **Inhalation/contact.** ALWAYS take precautions to avoid inhaling or coming into contact with the chemical.
- **Personal protective equipment.** ALWAYS wear protective clothing, eye protection, and chemical-resistant gloves when filling, using and cleaning the sprayer. Wear additional protective gear (such as facemask or apron) as recommended on the chemical label.
- **Children/pets.** Pesticides can be especially toxic to children and animals. ALWAYS exercise extra caution around children. Keep sprayer and all spray materials away from children and animals.
- **Ventilation.** ALWAYS ensure there is adequate ventilation when mixing, pouring, or spraying.
- **Flammables.** NEVER use any flammable chemicals in the sprayer.
- **Corrosives.** DO NOT use corrosive chemicals in the sprayer. They can weaken the sprayer and its parts, resulting in leaks. Check with the chemical manufacturer to ensure chemical is compatible with all components of the sprayer.
- **Chemical interaction.** ALWAYS flush the sprayer before switching chemicals. Different chemicals may interact dangerously with each other.
- **Chemical storage.** ALWAYS store pesticides in a properly labeled container and in a secure location per the manufacturer's recommendations.
- **Health monitoring.** Monitor the health of operators who are frequently exposed to pesticides, as recommended by the chemical label or local/federal regulations.

Operation – Important Safety Information (continued)

Chemical Application Safety:

WARNING

Caution must be used when spraying chemicals to avoid unsafe exposure to humans and the environment.

Heed the warnings below and follow all instructions carefully.

Before Spraying

- **Sprayer prep.** ALWAYS inspect and prepare the sprayer before use according to the directions provided in this manual.
- **Keep sprayer off.** Do not turn on power to the sprayer until ready to spray in order to avoid unintentional spray release.
- **Broadcast nozzle down.** Make sure broadcast nozzle is oriented to spray straight down before starting the sprayer. An incorrectly positioned broadcast nozzle may spray chemicals on you or others
- **Wind speed.** NEVER spray when wind speed exceeds 4 MPH in order to minimize spray drift.
- **Clear area/post.** ALWAYS keep the work area clear of people and pets. POST warning notices to restrict access by the public for the period recommended on chemical label.
- **Operator age.** You must be 16 years of age or older to operate this sprayer. Pesticides are especially toxic to children.

During Spraying

- **Over application.** DO NOT over apply pesticide. Apply at a rate recommended by chemical manufacturer. Excess pesticide can be dangerous to humans, damage desirable plants, and contaminate soil and water sources.
- **Never point gun.** NEVER point the spray gun at people or animals.
- **Children/pets.** ALWAYS exercise extra caution when spraying near areas accessible to children and pets.
- **Eating/smoking.** DO NOT eat, drink, smoke, rub your eyes, or touch any part of your bare skin while handling chemicals and spraying.
- **Heat/flames.** DO NOT spray near open flames or sources of heat.
- **Spills.** ALWAYS clean up spills immediately per instructions on the chemical label.
- **Unattended.** ALWAYS turn off vehicle and set brake or block wheels, turn off power to sprayer, and relieve system pressure before leaving sprayer unattended.
- **Troubleshooting.** ALWAYS refer to the safety instructions in the Troubleshooting Section before attempting any repairs.

After Spraying

- **Clean sprayer.** ALWAYS clean the sprayer immediately after use according to the directions provided in this manual.
- **Decontaminate.** ALWAYS decontaminate yourself immediately after you are finished spraying and handling chemicals. Wash all exposed areas of the body with soap and water and remove and launder clothing.
- **Chemical disposal/storage.** ALWAYS dispose of or store remaining chemicals properly as recommended on the chemical label.

Operation – Important Safety Information (continued)

Transporting sprayer:

WARNING

Serious injury can occur if the tractor on which the sprayer is mounted is driven unsafely.

1. Drive to desired location	<p>Drive tractor and sprayer carefully to the desired work site.</p> <p><u>Important safety instructions:</u></p> <ul style="list-style-type: none"> • Read tractor instructions. Review safety instructions in your tractor manual with regard to driving with 3-point hitch mounted equipment attached. • Securely attached. Be sure sprayer is securely attached before transporting. • Added length. Be aware of the added length of the sprayer. • Reduced road stability. Be aware that heavy, 3-point hitch mounted equipment can reduce road stability, regardless of the amount of front-end counterweight added. Drivers should take extra caution when driving with the sprayer attached. Reduce your speed and take extra caution during turns or while driving on rough or sloped terrain. • No riding or cargo on sprayer. Never ride or transport cargo on the sprayer. • On public roads. If transporting the sprayer on a public road, make sure to comply with all local, state, and federal requirements. • Unattended. Turn off the tractor before leaving the sprayer unattended. • Under the influence. Never transport or operate this sprayer while under the influence of alcohol, drugs, or medication.
2. Engage parking brake	<p>Make sure the tractor's parking brake is engaged before operating the sprayer.</p> <p> WARNING: If the parking brake is not engaged, the tractor could roll while you are operating the sprayer. Personal injury could result. Always engage the parking brake before leaving the tractor while the sprayer is attached.</p>

Chemical Accident Procedures:

WARNING

Before you fill the sprayer, review the following information with regard to handling accidents.

Chemical spills, sprayer leaks, personal contamination, and poisoning are accident situations which you may encounter. **All require an immediate response – See instructions below.**

Sprayer leak	<p>In the event that the sprayer develops a leak while spraying chemicals, you must <i>immediately stop spraying</i>.</p> <p>Turn off power to the sprayer and follow the directions below, as applicable.</p>
--------------	---

Operation – Important Safety Information (continued)

Bodily chemical contact	<p>Personal contamination can occur when chemicals splash, spill, or spray directly onto a person.</p> <ol style="list-style-type: none"> Follow the emergency first aid instructions on the chemical label listed in the "First Aid" or "Statements of Practical Treatment" section. <u>General procedures include:</u> <ol style="list-style-type: none"> Eyes – immediately flush with water or follow other directions as specified on the chemical label. Skin – immediately wash all contaminated skin surfaces with soap and water, or follow directions as specified on the chemical label. Clothing – remove contaminated clothing immediately. Dispose of heavily contaminated clothing per the instructions on the chemical label for safe chemical/container disposal. Seek medical advice if instructed on the label, or if the victim experiences symptoms of harmful effects such as burning, swelling, nausea, chest pain, difficulty breathing, dizziness or confusion. When seeking medical advice, be sure to bring the chemical product label.
Poisoning by ingestion or inhalation	<p>In case of poisoning from ingestion or inhalation:</p> <p>IF THE VICTIM HAS COLLAPSED OR IS NOT BREATHING, <u>CALL 911</u>.</p> <p>Otherwise:</p> <ol style="list-style-type: none"> If you are the victim, immediately seek assistance from nearby personnel because you may become incapacitated. Follow the emergency first aid instructions on the chemical label in the "First Aid" or "Statement of Practical Treatment" section. Call a poison control center for further advice. In the U.S., call 1-800-222-1222 to be automatically linked to the nearest certified poison control center. Have the chemical label available for reference.
Chemical spills	<p>Chemical spills must be quickly contained and properly cleaned up.</p> <p>Refer to the chemical label for any specific clean-up instructions with regard to the chemical spilled.</p> <p><u>General procedures include:</u></p> <ol style="list-style-type: none"> Control the spill by stopping the source of the spill. If the source of the spill is a container leak, place the leaking container in a larger, watertight container. Keep unprotected people away from the spill site. Contain the spill so that it does not spread and get into water sources. Use a shovel or other tool to make a dike around the spill with soil, sod, or absorbent material. Clean up the spill immediately -- Absorbent materials like ground corncobs or pet litter should be spread on the spill area to soak up the pesticide. The contaminated material should then be shoveled into a leak proof container. Do not flush the spill area with water until you receive advice as directed below. Seek additional advice from the chemical manufacturer and your state's pesticide regulatory agency regarding decontamination of the spill site: <ul style="list-style-type: none"> - <i>Chemical manufacturer.</i> The chemical label provides contact information for the chemical manufacturer. - <i>State pesticide regulatory agency.</i> In the U.S., call the National Pesticide Information Center at 1-800-858-7378 for assistance in determining how to contact your state's pesticide regulatory agency.

Operation – Preparing the Sprayer for Each Use

If the sprayer has been used previously, it must be prepared BEFORE EACH SUBSEQUENT USE.

⚠ WARNING

Read instructions below carefully for inspecting and preparing the sprayer.
 Damaged or clogged equipment could result in leaks or uncontrolled spray.
 Leaks could result in injury to the operator or bystanders from chemical exposure,
 or cause damage to the environment.

Important safety rules:

- **Power off.** Make sure all power is OFF before cleaning, inspecting, or servicing the sprayer.
- **Guards / shields.** Make sure all guards and shields are replaced after servicing the sprayer.
- **Replacement parts.** If a part needs replacement, only use parts that meet the manufacturer's specifications. Replacement parts that do not meet specifications may result in a safety hazard or poor operation of the sprayer.

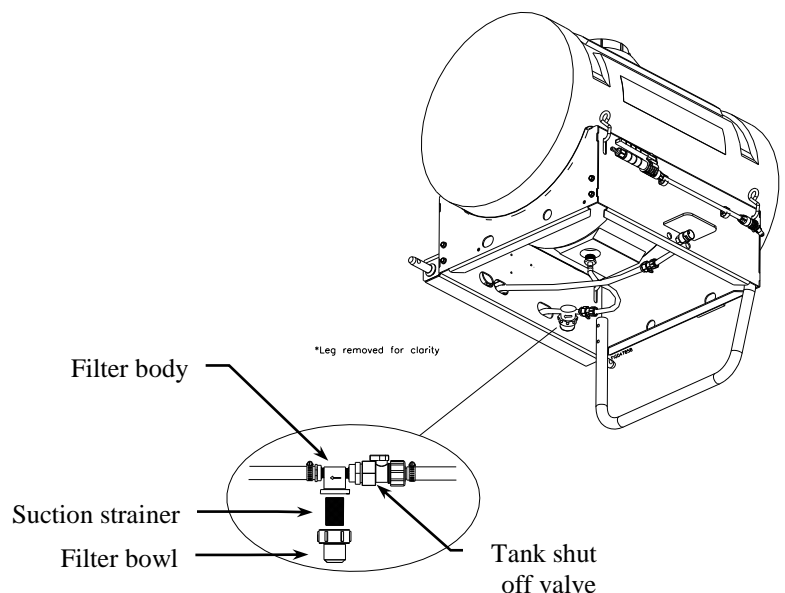
1. Ensure sprayer attached	Ensure the sprayer is securely attached to the vehicle.
2. Ensure tank empty	Ensure the sprayer has been thoroughly flushed and drained of all residual chemical from prior uses.
3. Clean suction strainer	<p>Clean the suction strainer of any chemical residue.</p> <p>It is important to clean the suction strainer before each use to ensure it is not clogged and to prevent residual chemical from contaminating sprayer contents.</p> <p>IMPORTANT: The strainer must be accessed by unthreading the tank shut off valve from the garden hose swivel nut.</p> <ol style="list-style-type: none"> a) Locate the tank shut off valve under the 3 point frame and close. b) USING RUBBER GLOVES, unthread the filter bowl from the filter body and remove the suction strainer. (See figure below.) c) Run the suction strainer under fresh water to remove debris. d) Reinsert the suction strainer. Screw the filter bowl onto the filter body. e) Open the valve to allow fluid to flow from tank to pump inlet. <div style="text-align: center; margin-top: 20px;">  <p style="margin-left: 100px;">*Leg removed for clarity</p> </div> <p style="margin-top: 20px;"><i>Note: It is not unusual for the operator to be exposed to chemical drips while cleaning the strainer – wear chemical resistant gloves</i></p>

Operation – Preparing the Sprayer for Each Use (continued)

4. Inspect & repair

Inspect and test the sprayer thoroughly:

- a) Inspect hoses for exposed mesh and holes. Replace all worn or damaged hoses.
 - b) Inspect tank and fittings for cracks and leaks. Replace all damaged fittings with original NorthStar parts.
 - c) Check to be sure retaining nut on gun nozzle is tight.
 - d) Check to be sure all other nuts, bolts, and screws are tight.
 - e) *Partially fill tank with plain water and spray to test for leaks.* Repair as needed.
- IMPORTANT: After any repair work has been done, ALWAYS test for leaks with water one final time before using.***

Operation – Using the Sprayer

Step One: Assess wind conditions and clear work area.

Before you decide to spray, you must determine whether wind conditions are suitable. You must also restrict access to the work area to ensure the safety of bystanders.

WARNING

Do not spray if wind speeds are greater than 4 MPH or if there are bystanders in the intended spray area.

1. Assess wind speed	Assess weather conditions to ensure that it is not too windy to spray. DO NOT SPRAY if wind speeds are greater than 4 MPH. <i>Visible indication of wind speed:</i> If leaves are in constant motion or there is any branch movement, DO NOT spray because the wind is too strong.
2. Clear work area	Clear the work area of all bystanders and pets. Restrict access by the public for the period recommended on chemical label.

Step Two: Fill the sprayer.

WARNING

ALWAYS wear personal protective equipment as directed on the chemical label when handling pesticides.

Long pants and sleeves, chemical resistant gloves, and eye protection are strongly recommended. Additional protective gear may be required depending on the particular pesticide.

Fill the sprayer using the following steps:

1. Review safety information	Review the "Operation – Important Safety Information" related to <u>General Chemical Safety</u> and <u>Chemical Accident Procedures</u> provided in this manual.
2. Choose safe mixing/loading area	Choose a safe pesticide mixing and loading area. - Choose an outdoor, well-ventilated area away from unprotected people, animals, food, and other items that might become contaminated.
3. Wear personal protective equipment	Wear personal protective equipment as directed on the chemical label. - Note that additional equipment may be specified for mixing and loading activities.
4. Turn off sprayer and vehicle	Turn OFF power to the sprayer before filling. - The vehicle should also be off, with brake set or wheels blocked to prevent unintended movement.

Operation - Using the Sprayer (continued)

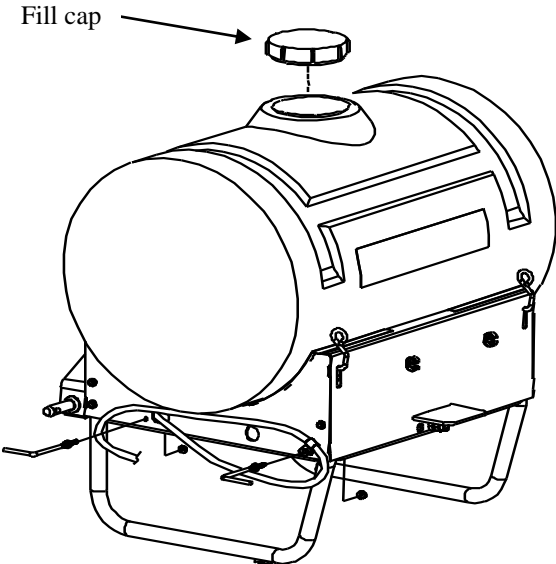
5. Remove fill cap	<p>Remove the fill cap located on top of the sprayer.</p> 
6. Ensure tank flushed	<p>Ensure tank is flushed of all chemicals from prior uses. - Chemicals can interact dangerously when mixed, and residue chemicals are also a health hazard.</p>
7. Fill tank	<p>Add pesticide to tank through fill cap:</p> <ul style="list-style-type: none"> a) Confirm the chemical/water dilution ratios specified on the chemical label. b) Determine chemical and water volumes needed for the planned application, taking into consideration that maximum tank capacity is 55 gallons <i><u>Note:</u> Only purchase and mix as much chemical as you need for the planned application in order to minimize chemical over application and the need for storing unused chemicals.</i> c) Add chemical to the tank through the fill cap. <i>If the chemical is not pre-mixed, add water and pesticide concentrate in the order prescribed on the label.</i>
8. Ensure chemical mixed	<p>Ensure chemical is thoroughly mixed in tank. - Stirring device should be made of metal or plastic, non-chemical absorbing material, and then properly cleaned and stored after use.</p>
9. Replace fill cap	<p>Replace fill cap and tighten securely.</p>

Operation - Using the Sprayer (continued)

Step 3: Operate the sprayer.

⚠ WARNING

ALWAYS wear personal protective equipment as directed on the chemical label when spraying.

Long pants and sleeves, chemical-resistant gloves, and eye protection are strongly recommended. Additional protective gear may be required depending on the particular pesticide.

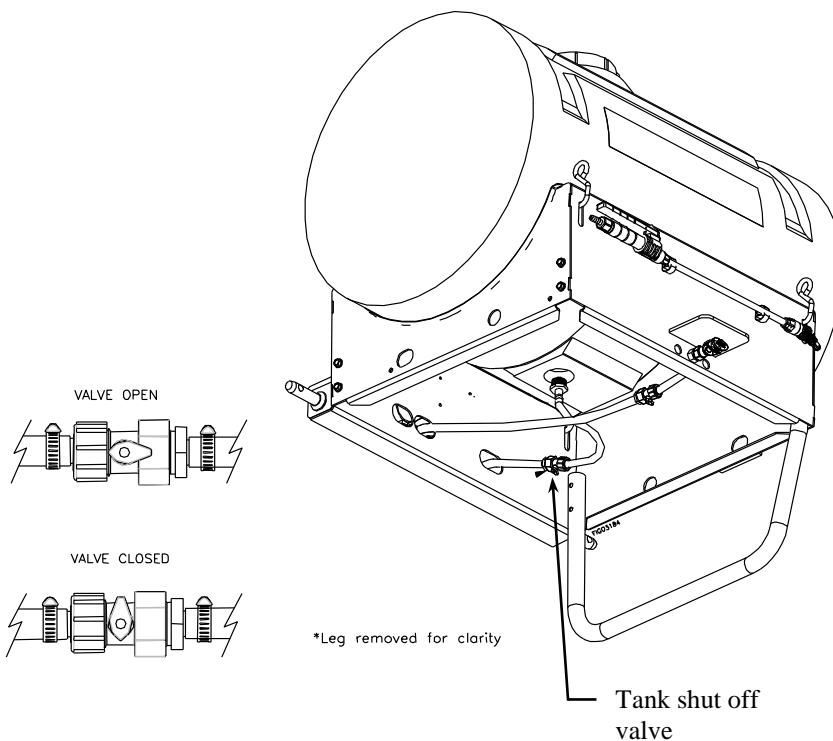
1. Review safety information	Review the "Operation – Important Safety Information" related to <u>Chemical Application Safety</u> and <u>Transporting Sprayer</u> provided in this manual.
2. Wear personal protective equipment	Wear personal protective equipment as directed on the chemical label.
3. Open tank shut off valve	Turn the tank shut off valve to the open position. <div data-bbox="558 882 1386 1617"></div>

Operation - Using the Sprayer (continued)

4. Close broadcast nozzle shut off valve

Turn the broadcast nozzle shut off valve to the closed position.

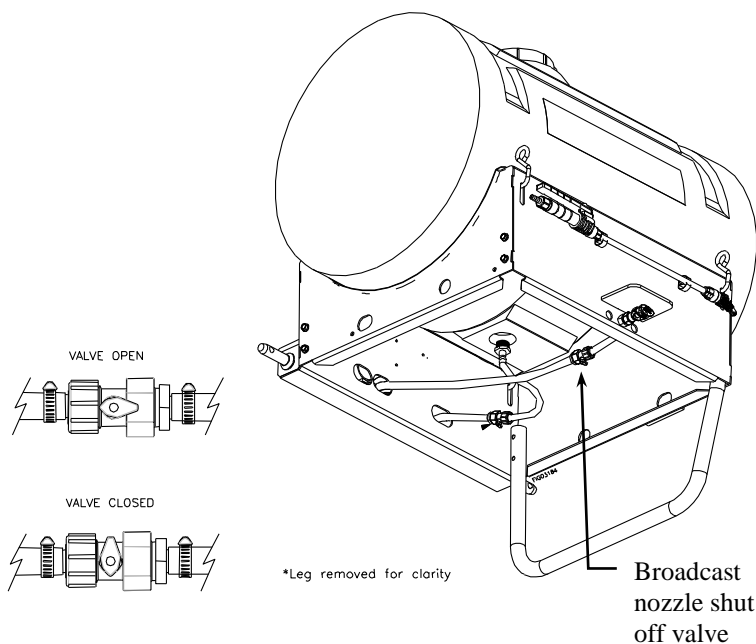

5. Turn on power

Turn on the power to the sprayer.

1. Verify the remote switch is connected to the pump power cord.
2. Turn the remote switch to the "ON" position.

Note: The pump will start automatically when power is turned on. The pump will cycle on and off as needed to retain pressure in the hose.

6. Squeeze trigger & adjust nozzle

To spray, squeeze the gun trigger.

- Twist the spray nozzle to adjust from a straight stream to hollow cone spray pattern, as recommended on the chemical label for proper delivery rate.

Note: It is not unusual for the operator to be exposed to chemical drips while adjusting the nozzle – wear chemical resistant gloves.

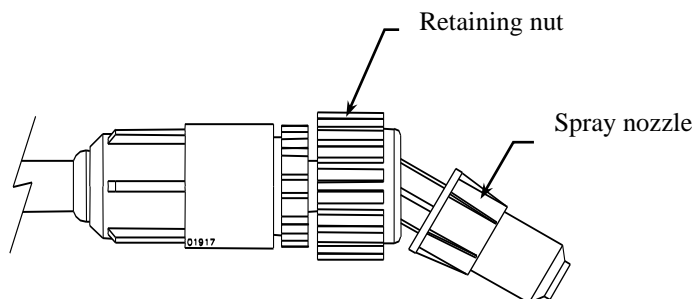

Operation - Using the Sprayer (continued)

7. Operate broadcast spraying system

A. Open broadcast nozzle shut off valve

Ensure power to the pump is off.

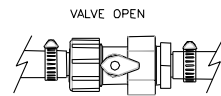

VALVE OPEN

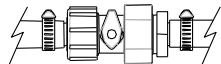

VALVE CLOSED

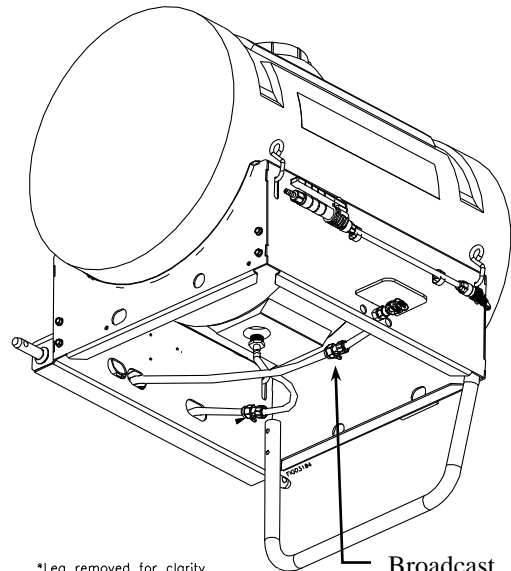

*Leg removed for clarity

Broadcast
nozzle shut
off valve

B. Ensure correct spray pattern

Rotate the broadcast nozzle, if needed, so that the spray pattern is pointed down and evenly distributed.

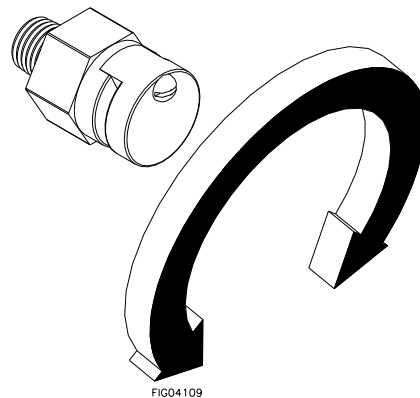

Note: It is not unusual for the operator to be exposed to chemical drips while adjusting the broadcast nozzle. Wear chemical resistant gloves.

Operation - Using the Sprayer (continued)

C. Begin to spray

Turn the power ON.

D. Ensure uniform coverage

To ensure proper coverage, overlap the ends of the spray pattern 12".

Use the tables in Appendix A to determine what speed to drive your vehicle for the desired application rate.

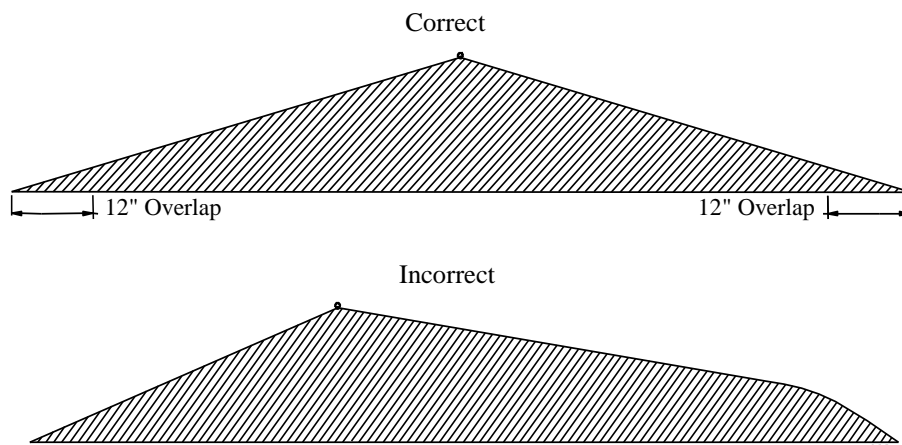

IMPORTANT: Make sure broadcast nozzle is oriented to spray straight down before you start. An incorrectly positioned broadcast nozzle may spray chemicals on you or others.

7. Leaving unattended	If the sprayer must be left unattended at any time: <ol style="list-style-type: none"> Disconnect power to the sprayer. Relieve system pressure by depressing the gun trigger. Turn off the vehicle. Set brake or block the wheels.
8. Discontinue use if clogged or inoperative	If the sprayer becomes clogged or inoperative during use, <i>discontinue use immediately.</i> <ul style="list-style-type: none"> - DO NOT attempt to service while chemicals are in the sprayer and power is connected. - Return to service area to review instructions for troubleshooting before attempting to service.

Note: A reserve, clean container capable of holding at least 55 gallons should be kept for use when the sprayer tank needs to be emptied temporarily for repairs. It is advisable to purchase a reserve tank suitable for pesticide storage from Northern Tool + Equipment for use in these circumstances. The container should be properly labeled as to its contents if it is used.

Operation - Using the Sprayer (continued)

Step Four: Clean sprayer and decontaminate after use.

When done using the sprayer, it is important to clean the sprayer and decontaminate yourself. Do not store the sprayer with chemicals in the tank, as it is unsafe and could also result in damage to the equipment.

! WARNING

Clean-up and decontamination procedures must be followed after each use.

Improper equipment clean-up and disposal of chemicals can result in dangerous chemical exposure to humans and the environment, as well as equipment damage.

Personal decontamination is required after spraying to minimize unsafe exposure to chemicals and potential illness.

1. Drain tank

If there is excess chemical left in the tank, drain the tank:

- Disconnect power to the sprayer and relieve system pressure by depressing the gun trigger
- Find a suitable container in which to drain the unused chemical. Position the container just beneath the hose from the tank to the pump inlet.
- While wearing rubber gloves, eye protection, and all other required personal protective equipment, unscrew the filter bowl and remove strainer and allow fluid to drain into the suitable container. (clean the suction strainer)
- When tank is empty, reinsert the suction strainer and screw the filter bowl back onto the filter body.

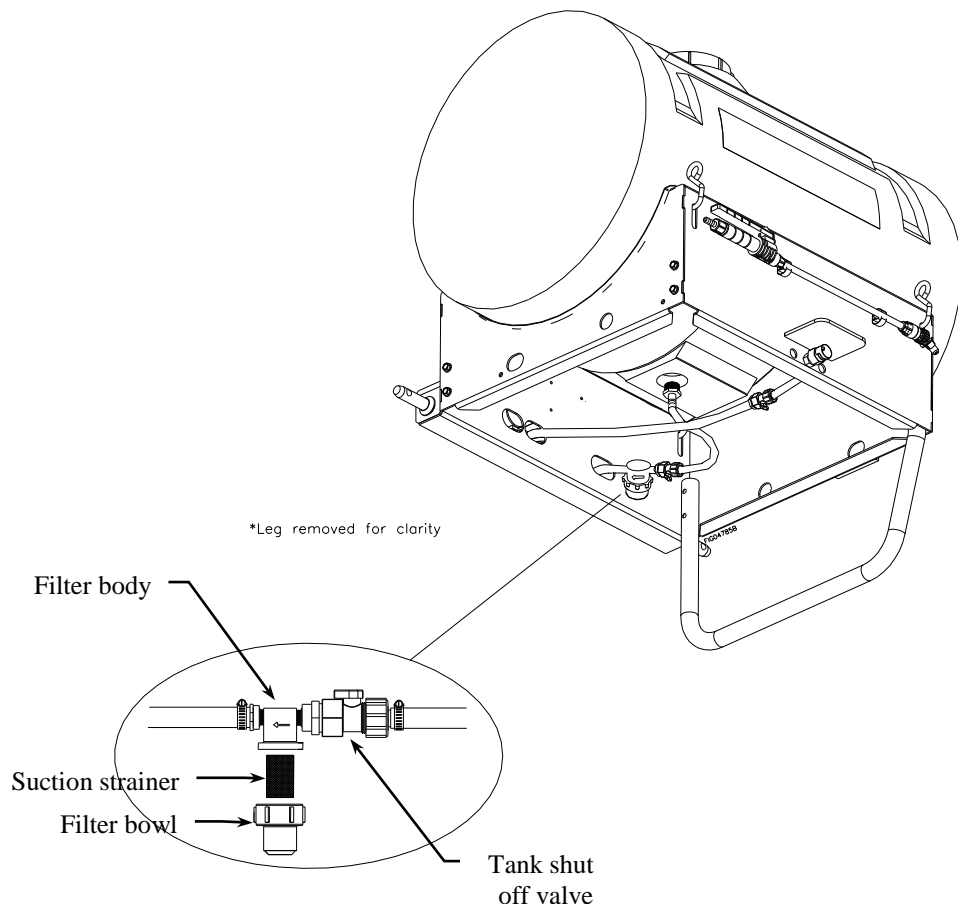

Operation - Using the Sprayer (continued)

2. Unused chemical	<p>Properly store or dispose of unused chemical:</p> <p>a) <u>If the unused pesticide is to be stored for future use:</u> Store all unused pesticide in its original, or a suitably marked, container in a secure location out of the reach of children & animals.</p> <p>b) <u>If remaining pesticide is to be disposed:</u> Properly dispose of the remaining chemical and its container per the chemical manufacturer's recommendation and according to local hazardous waste disposal regulations.</p>
3. Flush sprayer	<p>Flush the sprayer per the chemical manufacturer's recommendations. A general procedure is as follows:</p> <p>a) Add fresh water to the tank.</p> <p>b) Reconnect power to the sprayer.</p> <p>c) Operate the spray gun and discharge all rinse water onto an area that can accept dilute pesticide application.</p> <p>d) Add 5 gallons of the chemical manufacturer's recommended cleaning solution. Operate the spray gun, collecting the discharged solution if recommended by the manufacturer.</p> <p>e) After flushing, disconnect power to the sprayer and be sure all system pressure is relieved by squeezing the gun trigger.</p> <p>f) Dispose of cleaning solution discharge as recommended by the manufacturer of the solution.</p>
4. Decontaminate & launder	<p>Decontaminate yourself after you are finished handling chemicals:</p> <p>a) Remove all clothing worn during spraying and chemical handling.</p> <p>b) Wash all exposed parts of the body with soap and water.</p> <p>c) Launder clothing separately from other wash.</p>

Storage

When not in use, store the sprayer indoors. For long term or winter storage, prepare the sprayer by running RV antifreeze through the system. This will keep internal parts lubricated, protect against corrosion, and keep the unit from freezing.

CAUTION

The sprayer will be damaged if it freezes.

Protect the sprayer from freezing during storage by following the instructions below.

Preparing for storage:

1. Add antifreeze	Pour 1 gallon of RV antifreeze into the tank. <i><u>Note:</u> RV antifreeze is non-toxic and biodegradable and generally safer for the environment than automotive antifreeze.</i>
2. Spray briefly	Turn on the pump motor and squeeze the gun trigger briefly until fluid sprays. Store gun in lance clips.

Removing from storage:

1. Drain	Drain the antifreeze left in the tank into a suitable container.
2. Flush with water	Fill the tank with fresh water and run through the system. Operate the spray gun until the system is completely flushed. Be sure to set up containers to capture the antifreeze flush water.
3. Disposal	Dispose of the antifreeze and flush water properly.

Troubleshooting

WARNING

Before troubleshooting or attempting to service, read the following safety rules to avoid accidental exposure to chemical and also risk of electric shock.

***Note:** A reserve, clean container capable of holding at least 55 should be kept for use when the sprayer tank needs to be emptied temporarily for repairs. It is advisable to purchase a reserve tank suitable for pesticide storage from Northern Tool + Equipment for use in these circumstances. The container should be properly labeled as to its contents if it is used.*

Before attempting to service the sprayer:

1. Personal protective equipment	Wear personal protective equipment as directed on the chemical label while servicing your sprayer.
2. Review troubleshooting table	Review the Troubleshooting Table below for the type of problem you are experiencing. However, DO NOT attempt to repair until the steps listed below are followed.
3. Empty and flush	If the cause listed for your problem is a Clogged suction strainer, or Worn spray gun nozzle: empty the tank and flush the sprayer with water as directed in the section, "Operation – Step Four". <i>- In order to avoid accidental exposure to chemicals, never attempt to unclog the suction strainer, or service the spray gun nozzle, until the tank has been emptied and the sprayer flushed with water.</i>
4. Disconnect power/relieve pressure	Disconnect power to the sprayer and be sure all system pressure is relieved by squeezing the gun trigger.
5. Perform repairs	Follow the directions provided in the troubleshooting table to repair the sprayer. <i>NOTE: Never try to unclog the sprayer nozzle by blowing through it.</i>
6. Test after servicing	After servicing, ALWAYS test the sprayer for leaks with plain water before using.

PROBLEM	CAUSE	SOLUTION
Pump will not turn on	Bad electrical connection	Check battery connections
	Fuse blown	Replace fuse
	Short in wires	Check condition of wires
	Low voltage	Check voltage
Low pressure	Worn spray gun nozzle	Replace spray gun
	Worn broadcast nozzle	Replace broadcast nozzle
Low flow	Clogged suction strainer	Clean suction strainer
	Low voltage	Check voltage
Poor spray distribution	Suction strainer clogged	Clean suction strainer
	Worn spray gun nozzle	Replace spray gun
Pump cycles while not spraying	Leak in the system	Tighten leaking hose clamps or fittings, replace spray gun

Specifications

Electrical System Requirements

Electrical connection.....	12 VDC
Amp draw from pump.....	8 Amps

Sprayer Specifications

Maximum GPM.....	2.2 GPM (8.3 Liters/min.)
Maximum Pressure.....	70 PSI (4.8 Bar)

Tank Maximum Capacity.....	55 Gallons (208.20 Liters)
----------------------------	----------------------------

Overall Dimensions.....	L x W x H 39.0" x 30.0" x 40.0" (99.1cm x 76.2cm x 101.6cm)
-------------------------	---

Dry Weight / Weight full of water.....	95 lbs. / 535 lbs. (43 kg./243 kg.)
--	-------------------------------------

Broadcast Nozzle Specifications

Spray Width	192 in. (488 cm)
Spray Overlap	12 in. (30 cm)

Component Materials*

Tank.....	Polyethylene, EPDM
Fittings.....	Polypropylene, Nylon
Hose.....	PVC
Pump.....	Polypropylene, Viton®, Santoprene®, Stainless Steel
Valves.....	Nylon, Buna-N
Gun and Nozzle.....	Nylon, Polyacetal, Aluminum

*Before using any chemical, check to ensure the chemical is compatible with all materials in the system.

Note:

The sprayer is not compatible with bleach, chlorine or ice control chemicals. Also, pumping any petroleum based fluid (gasoline, diesel, kerosene, oil) will severely damage the pump.

The manufacturer reserves the right to make improvements in design and/or changes in specifications at any time without incurring any obligation to install them on units previously sold.

Any Questions, Comments, Problems or Parts Orders
Call NorthStar Product Support 1-800-270-0810

Exploded View – 2681781 – Rev H

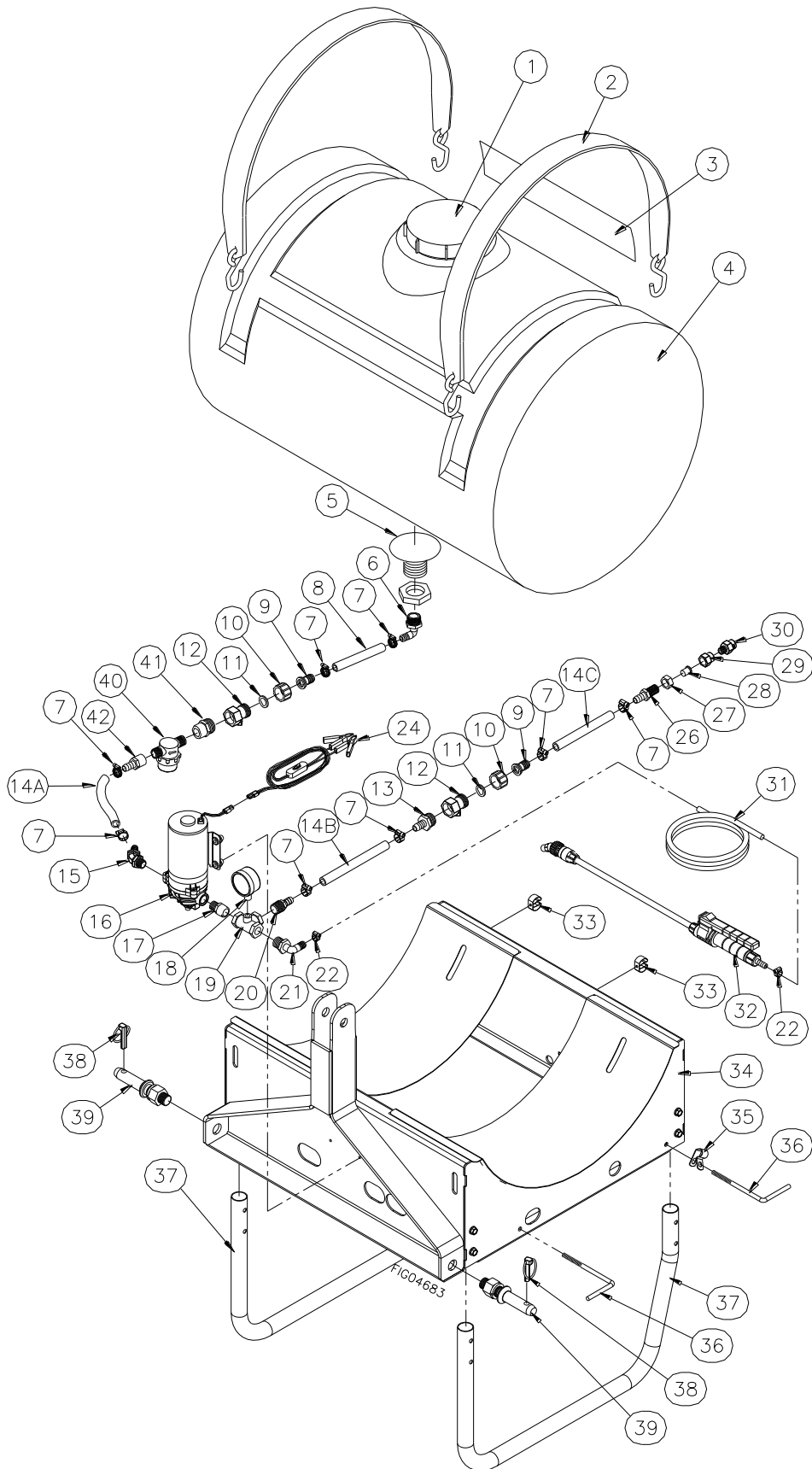

Exploded View – 2681781 – Rev H

Ref#	Part#	Description	Qty
1	SNY34300047	Tank lid	1
2	782010	Tank strap w/ ratchet	2
3	779319	NorthStar label	1
4	796780	55 Gallon tank assembly (includes item 3)	1
5	SNY34700002	Anti-vortex fitting	1
6	779269	3/4" MPT X 1/2" HB elbow	1
7	777119	1/2" Hose clamp	8
8	30160	1/2" PVC hose	2.5"
9	5212	1/2" Flat seat hose barb	2
10	777850	Garden hose swivel nut	2
11	5232	Rubber washer	2
12	782025	Shut off valve	2
13	5222	3/4" GHT x 1/2" HB straight	1
14A	30160	1/2" PVC hose	8"
14B			12"
14C			12"
15	787199	QC x 1/2" HB elbow	1
16	794992	2.2gpm NorthStar pump	1
17	787195	QC x 1/2" MNPT	1
18	777848	Pressure gauge	1
19	5377	1/2" FPT tee	1
20	777445	1/2" MPT X 1/2" HB straight	1
21	35082	1/2" MPT X 3/8" HB elbow	1
22	30746	3/8" Hose clamp	2
24	798370	Wire harness w/ switch	1
26	777454	1/2" HB X 11/16" thread nozzle body	1
27	5230	11/16" thread nozzle body nut	1
28	253121	Anti-drip nozzle filter	1
29	38545	11/16" thread x 1/4" FPT adapter	1
30	36576	Broadcast nozzle	1
31	30290	3/8" PVC hose	210"
32	779769	Spray gun	1
33	52034	Lance clip	2
34	781906	3-Point sprayer frame	1
35	777110	Strain relief clip	1
36	38510	Hose hook	2
37	781910	Leg	2
38	39159	Lynch pin	2
39	2501930	Draw pin	2
40	789676	Inline filter, clear bowl mesh 40	1
41	787086	3/4"MGHT X 1/2"FPT, nylon	1
42	777645	1/2" FPT X 1/2" HB straight	1

Exploded View – 2681781 – Rev H

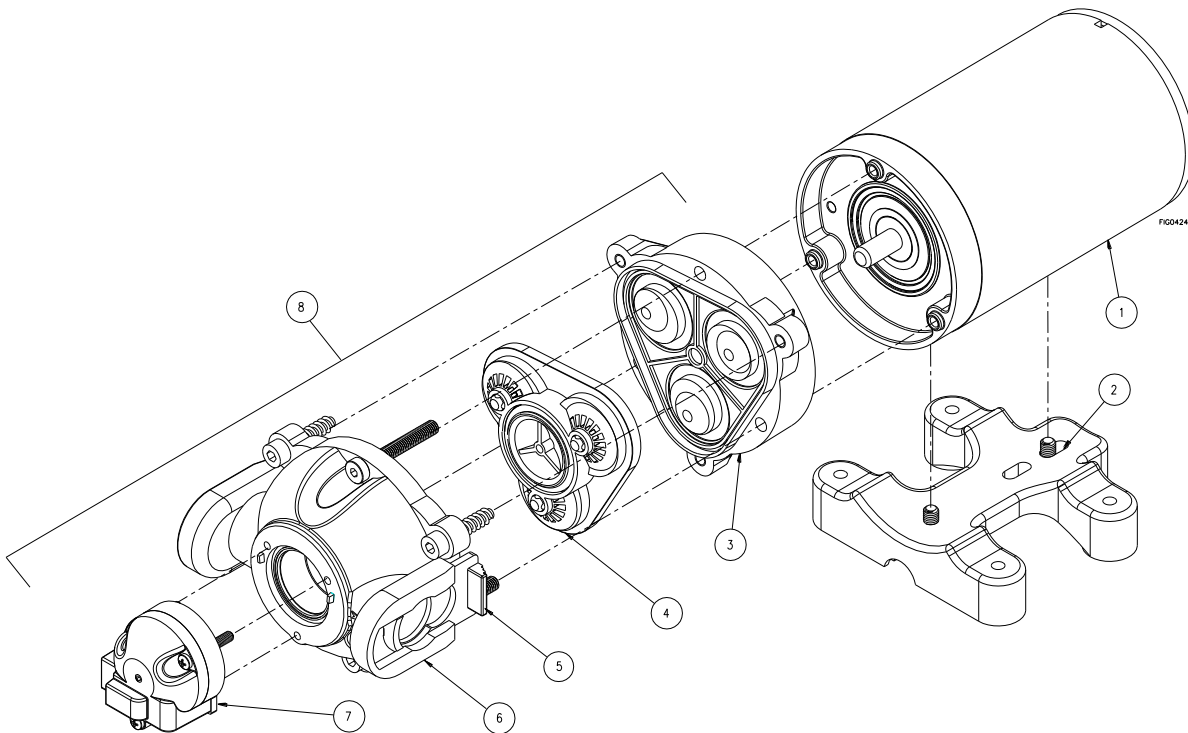

Ref#	Part#	Description	Qty
1	800132	Motor assembly	1
2	800428	Base plate assembly	1
3	794988	Diaphragm assembly	1
4	784989	Valve plate assembly	1
5	787015	Quick connect clip	2
6	787011	Upper housing assembly	1
7	786948	Pressure switch assembly	1
8	A2682272	Complete pump head assembly	1
N/A	787380	Replacement fuse	1

Appendix A –Broadcast Spray Calibration Tables

Below are some guidelines to help you calibrate your broadcast sprayer. This is a very important step in operating the broadcast sprayer such that too much or too little chemical may be applied.

1. Using **Table 1**, find a table that corresponds with the chemical manufacturer's suggested application rate (gallons per acre, gallons per 1000 sq. ft., or gallons per 100 sq. ft.).
2. Find the application rate that is closest to the chemical manufacturer's recommendations.
3. The speed to drive your tractor is listed below the application rates.

TABLE 1

Gallons per Acre (based on 36" spraying height and 14ft spray pattern)					
Application Rate	49.5	36	16.5	12	10
Speed To Drive	1 MPH	2 MPH	3 MPH	4 MPH	5 MPH

Gallons per 1000 Sq.Ft. (based on 36" spraying height and 14ft spray pattern)					
Application Rate	1.14	.83	.38	.28	.23
Speed To Drive	1 MPH	2 MPH	3 MPH	4 MPH	5 MPH

Gallons per 100 Sq.Ft. (based on 36" spraying height and 14ft spray pattern)					
Application Rate	.114	.083	.038	.028	.023
Speed To Drive	1 MPH	2 MPH	3 MPH	4 MPH	5 MPH

4. Use **Table 2** to choose the throttle setting on your tractor.

TABLE 2

Speed (MPH)	Time required in seconds to travel a distance of:		
	100 ft.	200 ft.	300 ft.
1	68	136	205
2	34	68	102
3	23	45	68
4	17	34	51
5	14	28	41
6	11	23	34
7	9.5	19	29

5. The coverage area can be found by dividing tank size by the application rate.

Example: 55 gallons divided by 12 gallons/acre = 4.58 acre of coverage per tank.

Finding the MPH to run your vehicle for desired performance.

$$MPH = \frac{\text{GALLONSPER MINUTE} \times 136}{\text{SPRAY WIDTH IN INCHES} \times \text{GAL. PER 1000 FT}^2}$$

$$MPH = \frac{\text{GALLONSPER MINUTE} \times 5940}{\text{SPRAY WIDTH IN INCHES} \times \text{GALLONSPER ACRE}}$$

This page has intentionally been left blank.

Limited Warranty

Dear Valued Customer:

The NorthStar Product you just purchased is built with the finest material and craftsmanship. Use this product properly and enjoy the benefits from its high performance. By purchasing a NorthStar product, you show a desire for quality and durability. Like all mechanical equipment this unit requires a due amount of care. Treat this unit like the high quality piece of machinery it is. Neglect and improper handling may impair its performance. Please thoroughly read the instructions and understand the operation before using your product.

Limited Warranty

NorthStar shall warranty any piece of equipment manufactured, or parts of equipment manufactured, to be free from defects in material or workmanship for a period of 2 years for noncommercial/nonrental use and a period of 90 days for commercial/rental use from the date of purchase by user.

NorthStar shall warranty any wear item, including, but not limited to, valves, seals, pump diaphragms, hoses, and filter elements to be free from defects in material or workmanship for a period of 90 days from the date of purchase by user. This warranty applies to the original purchaser of the equipment and is non-transferable. Verification of purchase is the responsibility of the buyer. Parts will be replaced or repaired at no charge, except when the equipment has failed due to lack of proper maintenance. Any misuse, abuse, alteration or improper installation or operations will void warranty. Determining whether a part is to be replaced or repaired is the sole decision of NorthStar.

NOTE: Some services performed by parties other than NorthStar may void warranty.

This warranty covers parts only. It will not provide for replacement of complete products due to defective parts.

Components not manufactured by NorthStar are guaranteed by their manufacturer and can be serviced at factory-authorized locations near you. Any costs incurred due to replacement or repair of items outside of a NorthStar approved facility is the responsibility of the buyer and not covered under warranty. NorthStar can supply you with the service center location in your area.

This warranty specifically excludes the following; failure of parts due to damage caused by accident, fire, flood, windstorm, acts of God, applications not approved by NorthStar in writing, corrosion caused by chemicals, use of replacement parts which do not conform to manufacturer's specifications, and damage caused by vandalism. Additional exclusions: loss of running time, inconvenience, loss of income, or loss of use, including any implied warranty of merchantability of fitness for a specific use.

Warranty does not cover items subject to normal wear such as tires, receptacles or any part subject to direct physical contact by the public. This warranty does not cover any personal injury or damage to surrounding property caused by failure of any part.

This warranty is in lieu of any other warranty expressed or implied and NorthStar assumes no other responsibility or liability outside that expressed within this warranty.

Please fill in the following information and have it on hand when you call in on a warranty claim.

Customer Number: _____

Date of Purchase: _____

NorthStar Serial Number: _____

Item Number: _____



Assembled by
Northern Tool & Equipment Company, Inc.
Burnsville, MN 55306
NorthernTool.com